

| LEGEND | |
|--------|-------------------------|
| | IP/FD |
| | TREE |
| | APPRX HOTEL |
| | TREELINE |
| | LEDGE |
| | S. PATENS (E2EM1) |
| | S. ALTERNIFLORA (E2EM1) |
| | COBBLE/GRAVEL (E2US1) |
| | LAWN |

- PLAN REFERENCES
1. PLAN ENTITLED "EXISTING CONDITIONS PLAN FOR GENE A. AUTY AND CHRISTOPHER J. AUTY" DATED NOV. 24, 2004 BY DOUCET SUREVEY, INC., NEWMARKET, NH
 2. PLAN ENTITLED "FOUNDATION LAYOUT FOR DON. L. THOMPSON" BY LAMPREY RIVER SURVEY COMPANY, NEWMARKET, NH
 3. PLAN BY NH SOIL CONSULTANTS, NEW MARKET, NH DATED 8/1990 INDICATING ON-SITE SEWAGE DISPOSAL SYSTEM

BRUCE BARSTOW

PROPOSED SHORELINE STABILIZATION

Date: 11/6/2012

Drawn By: APF

Checked By: ZCT

Address: 30 COLONY COVE ROAD

City: DURHAM, NH

Map & Lot #: MAP 12 LOT 23-1

Drawing Scale: 1"=20'

Approved: _____

Title: _____

RIVERSIDE PICKERING

MARINE CONTRACTORS

| REVISIONS | Approved | |
|-----------|-------------|------|
| | Description | Date |
| | | |

File #:

508-12

Sheet

1 of 3

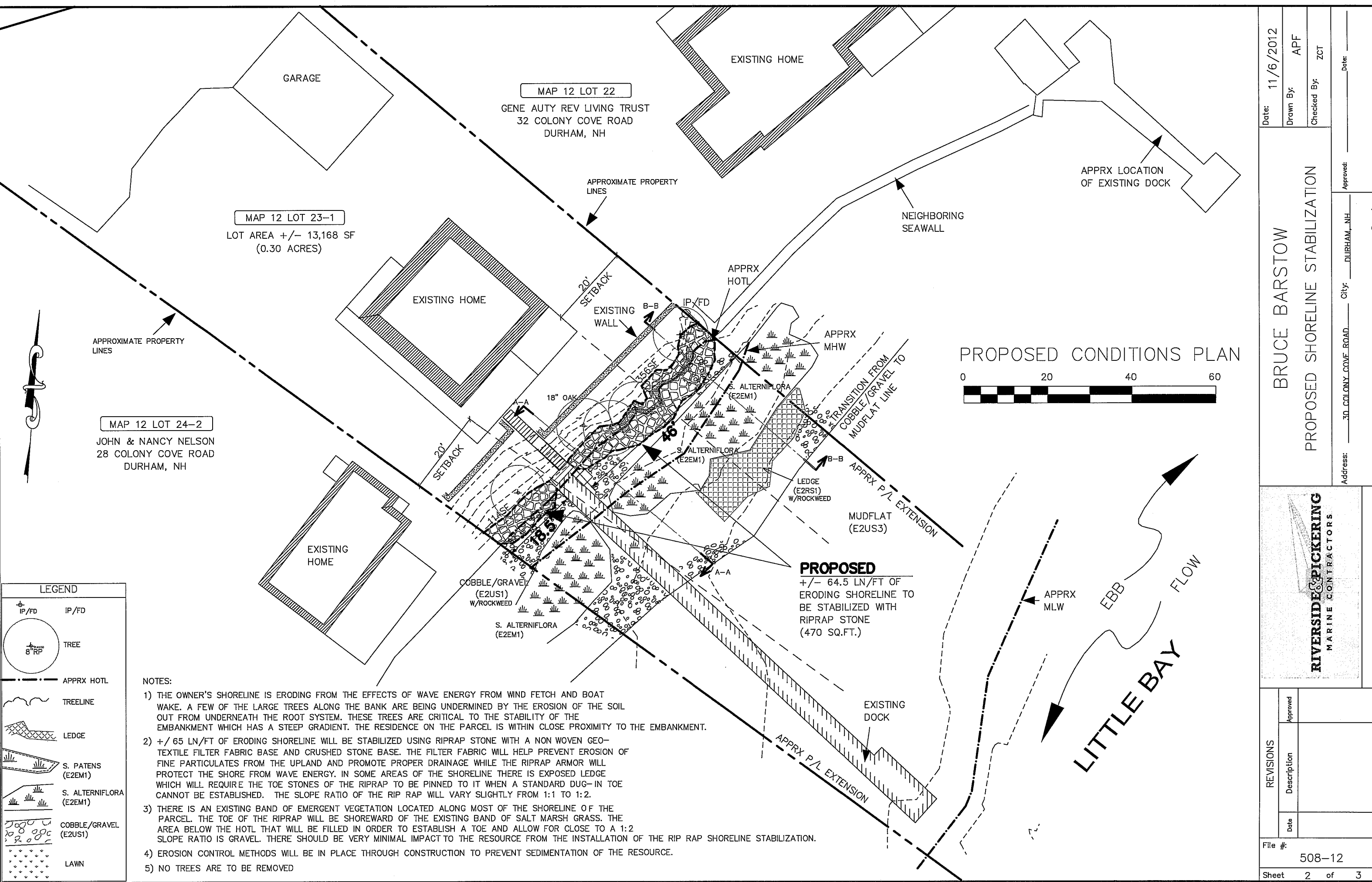

| LEGEND | |
|--------|-------------------------|
| | IP/FD |
| | TREE |
| | APPRX HOTL |
| | TREELINE |
| | LEDGE |
| | S. PATENS (E2EM1) |
| | S. ALTERNIFLORA (E2EM1) |
| | COBBLE/GRAVEL (E2US1) |
| | LAWN |

- NOTES:
- 1) THE OWNER'S SHORELINE IS ERODING FROM THE EFFECTS OF WAVE ENERGY FROM WIND FETCH AND BOAT WAKE. A FEW OF THE LARGE TREES ALONG THE BANK ARE BEING UNDERMINED BY THE EROSION OF THE SOIL OUT FROM UNDERNEATH THE ROOT SYSTEM. THESE TREES ARE CRITICAL TO THE STABILITY OF THE EMBANKMENT WHICH HAS A STEEP GRADIENT. THE RESIDENCE ON THE PARCEL IS WITHIN CLOSE PROXIMITY TO THE EMBANKMENT.
 - 2) +/- 65 LN/FT OF ERODING SHORELINE WILL BE STABILIZED USING RIPRAP STONE WITH A NON WOVEN GEO-TEXTILE FILTER FABRIC BASE AND CRUSHED STONE BASE. THE FILTER FABRIC WILL HELP PREVENT EROSION OF FINE PARTICULATES FROM THE UPLAND AND PROMOTE PROPER DRAINAGE WHILE THE RIPRAP ARMOR WILL PROTECT THE SHORE FROM WAVE ENERGY. IN SOME AREAS OF THE SHORELINE THERE IS EXPOSED LEDGE WHICH WILL REQUIRE THE TOE STONES OF THE RIPRAP TO BE PINNED TO IT WHEN A STANDARD DUG-IN TOE CANNOT BE ESTABLISHED. THE SLOPE RATIO OF THE RIP RAP WILL VARY SLIGHTLY FROM 1:1 TO 1:2.
 - 3) THERE IS AN EXISTING BAND OF EMERGENT VEGETATION LOCATED ALONG MOST OF THE SHORELINE OF THE PARCEL. THE TOE OF THE RIPRAP WILL BE SHOREWARD OF THE EXISTING BAND OF SALT MARSH GRASS. THE AREA BELOW THE HOTL THAT WILL BE FILLED IN ORDER TO ESTABLISH A TOE AND ALLOW FOR CLOSE TO A 1:2 SLOPE RATIO IS GRAVEL. THERE SHOULD BE VERY MINIMAL IMPACT TO THE RESOURCE FROM THE INSTALLATION OF THE RIP RAP SHORELINE STABILIZATION.
 - 4) EROSION CONTROL METHODS WILL BE IN PLACE THROUGH CONSTRUCTION TO PREVENT SEDIMENTATION OF THE RESOURCE.
 - 5) NO TREES ARE TO BE REMOVED

| | |
|---|---------------------------------------|
| Date: | 11/6/2012 |
| Drawn By: | APF |
| Checked By: | ZCT |
| Approved: | Date: |
| BRUCE BARSTOW PROPOSED SHORELINE STABILIZATION | |
| Address: | 30 COLONY COVE ROAD, CITY: DURHAM, NH |
| Map & Lot #: | MAP 12 LOT 23-1 |
| Drawing Scale: | 1"=20' |
| Job Class: | |
| RIVERSIDE & PICKERING MARINE CONTRACTORS | |
| REVISIONS | Approved |
| Description | |
| Date | |
| File #: | 508-12 |
| Sheet | 2 of 3 |

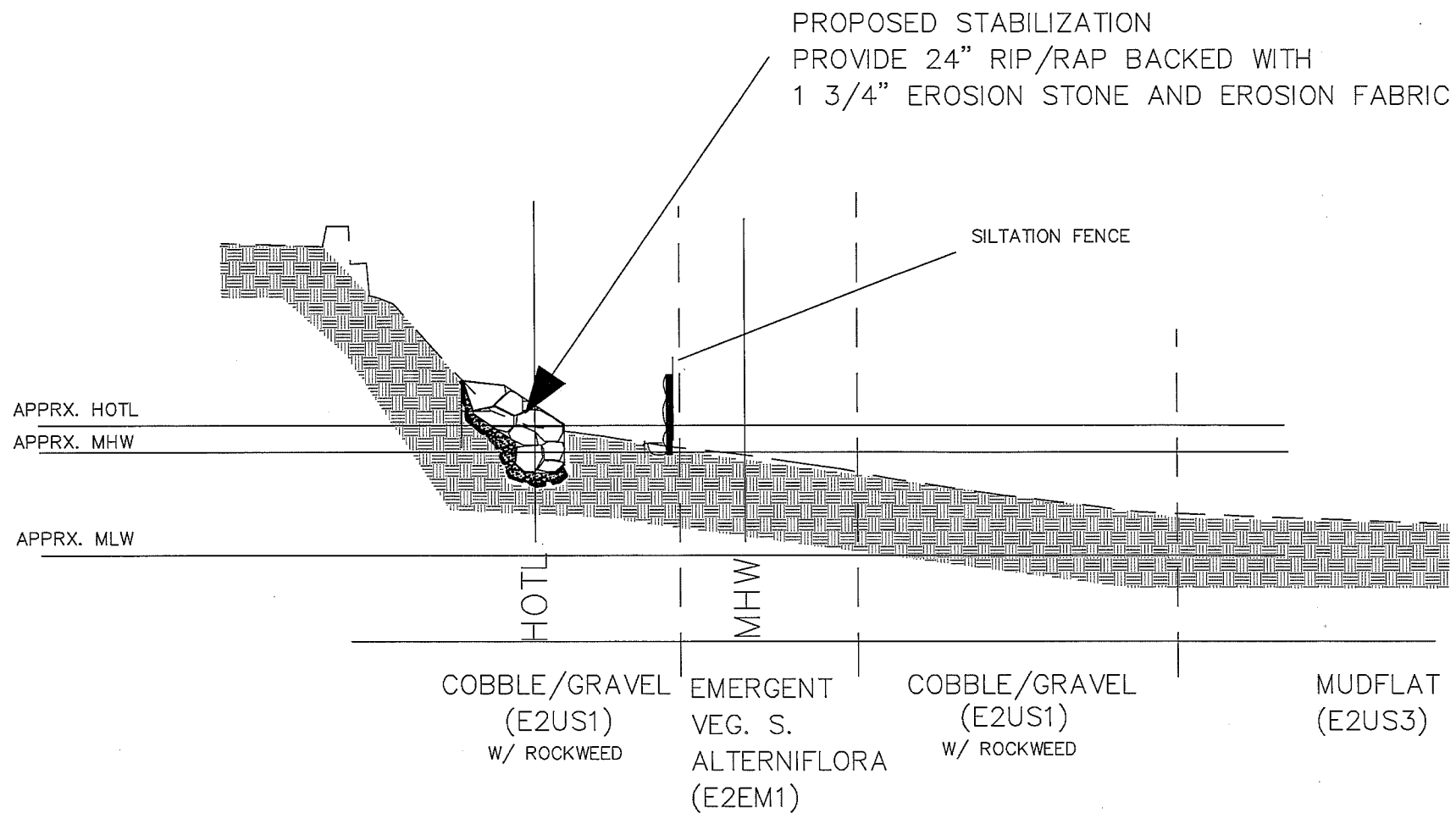

SECTION A-A

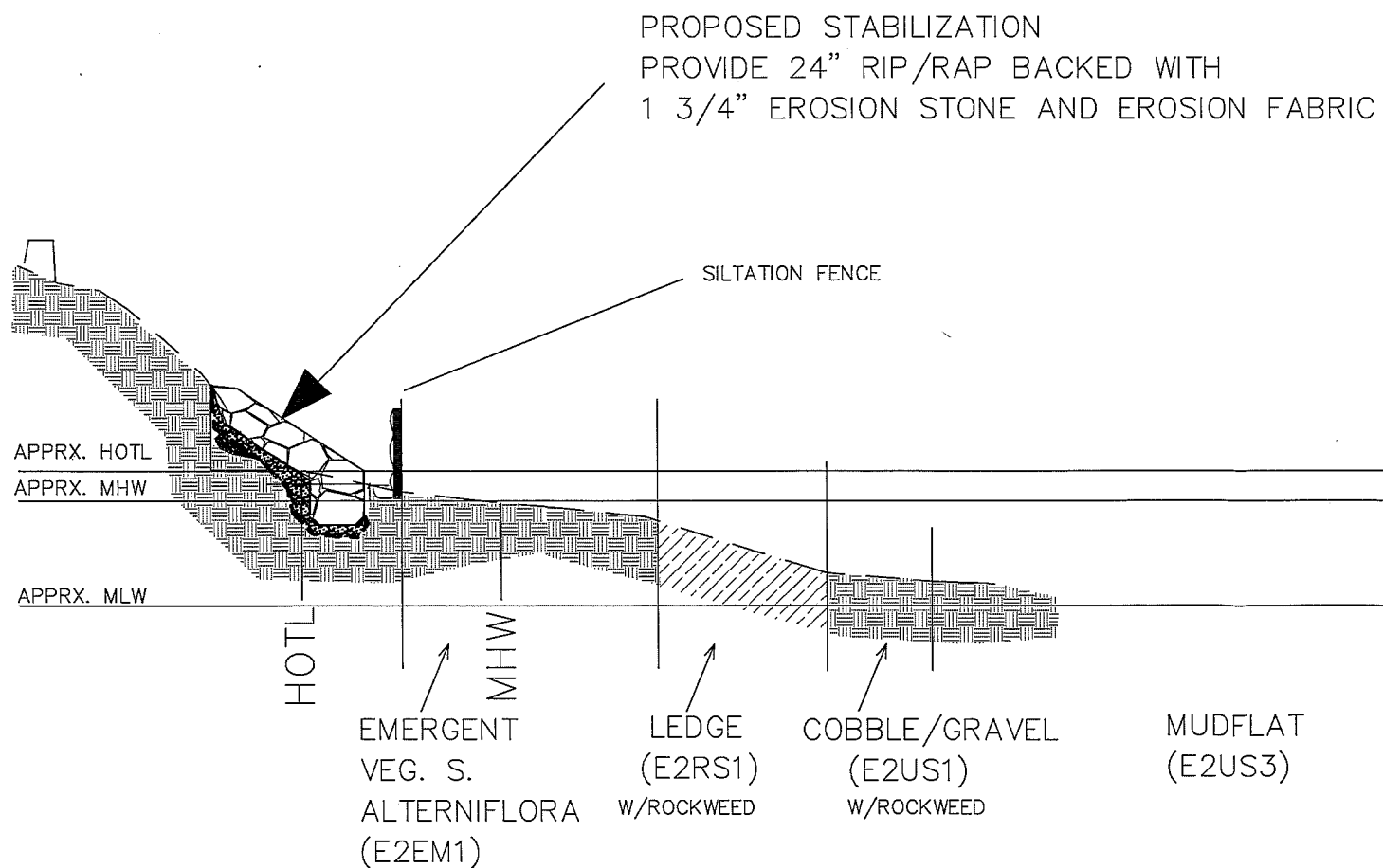
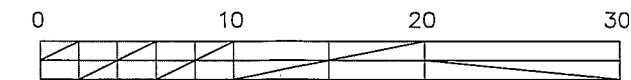

SECTION B-B

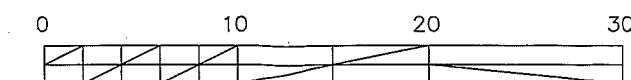

Date: 11/6/2012

Drawn By: APF

Checked By: ZOT

Date: _____

Job Class: _____

BRUCE BARSTOW PROPOSED SHORELINE STABILIZATION

Approved: _____

City: DURHAM, NH

Address: 30 COLONY COVE ROAD

Map & Lot #: MAP 12 LOT 23-1

Drawing Scale: 1"=10'

Title: _____

RIVERSIDE & PICKERING
MARINE CONTRACTORS

| REVISIONS | Description | Date | Approved |
|-----------|-------------|------|----------|
| | | | |

File #: 508-12

Sheet 3 of 3

