

DEMOLITION NOTES:

1. THE LOCATIONS OF UNDERGROUND UTILITIES ARE APPROXIMATE AND THE LOCATIONS ARE NOT GUARANTEED BY THE OWNER OR THE ENGINEER. IT IS THE CONTRACTOR'S RESPONSIBILITY TO LOCATE ALL UTILITIES, ANTICIPATE CONFLICTS, REPAIR EXISTING UTILITIES AND RELOCATE EXISTING UTILITIES REQUIRED TO COMPLETE THE WORK.
2. ALL MATERIALS SCHEDULED TO BE REMOVED SHALL BECOME THE PROPERTY OF THE CONTRACTOR UNLESS OTHERWISE SPECIFIED. THE CONTRACTOR SHALL DISPOSE OF ALL MATERIALS OFF-SITE IN ACCORDANCE WITH ALL FEDERAL, STATE, AND LOCAL REGULATIONS, ORDINANCES AND CODES.
3. COORDINATE REMOVAL, RELOCATION, DISPOSAL OR SALVAGE OF UTILITIES WITH THE OWNER AND APPROPRIATE UTILITY COMPANY.
4. ANY EXISTING WORK OR PROPERTY DAMAGED OR DISRUPTED BY CONSTRUCTION/ DEMOLITION ACTIVITIES SHALL BE REPLACED OR REPAIRED TO MATCH ORIGINAL EXISTING CONDITIONS BY THE CONTRACTOR AT NO ADDITIONAL COST TO THE OWNER.
5. THE CONTRACTOR SHALL VERIFY LOCATION OF ALL EXISTING UTILITIES. CALL DIG SAFE AT LEAST 72 HOURS PRIOR TO THE COMMENCEMENT OF ANY DEMOLITION/CONSTRUCTION ACTIVITIES.
6. SAWCUT AND REMOVE PAVEMENT ONE FOOT OFF PROPOSED EDGE OF PAVEMENT OR EXISTING CURB LINE IN ALL AREAS WHERE PAVEMENT IS TO BE REMOVED ABUTS EXISTING PAVEMENT OR CONCRETE TO REMAIN.
7. IT IS THE CONTRACTOR'S RESPONSIBILITY TO FAMILIARIZE THEMSELVES WITH THE CONDITIONS OF ALL OF THE PERMIT APPROVALS.
8. THE CONTRACTOR SHALL OBTAIN AND PAY FOR ADDITIONAL PERMITS, NOTICES AND FEES NECESSARY TO COMPLETE THE WORK AND ARRANGE FOR AND PAY FOR NECESSARY INSPECTIONS AND APPROVALS FROM THE AUTHORITIES HAVING JURISDICTION.
9. THE CONTRACTOR SHALL BE RESPONSIBLE FOR ALL DEMOLITION AND OFF-SITE DISPOSAL OF MATERIALS REQUIRED TO COMPLETE THE WORK, EXCEPT FOR WORK NOTED TO BE COMPLETED BY OTHERS.
10. UTILITIES SHALL BE TERMINATED AT THE MAIN LINE PER UTILITY COMPANY STANDARDS. THE CONTRACTOR SHALL REMOVE ALL ABANDONED UTILITIES LOCATED WITHIN THE LIMITS OF WORK. CONTRACTOR SHALL VERIFY ORIGIN OF ALL DRAINS AND UTILITIES PRIOR TO REMOVAL/TERMINATION TO DETERMINE IF DRAINS OR UTILITY IS ACTIVE AND SERVICES ANY ON OR OFF-SITE STRUCTURE TO REMAIN. CONTRACTOR SHALL NOTIFY ENGINEER IMMEDIATELY OF ANY SUCH UTILITY FOUND AND SHALL MAINTAIN THESE UTILITIES UNTIL PERMANENT SOLUTION IS IN PLACE.
11. PAVEMENT REMOVAL LIMITS ARE SHOWN FOR CONTRACTOR'S CONVENIENCE. ADDITIONAL PAVEMENT REMOVAL MAY BE REQUIRED DEPENDING ON THE CONTRACTOR'S OPERATION. CONTRACTOR TO VERIFY FULL LIMITS OF PAVEMENT REMOVAL PRIOR TO BID.
12. THE CONTRACTOR SHALL REMOVE AND DISPOSE OF ALL EXISTING STRUCTURES, CONCRETE PADS, UTILITIES AND PAVEMENT WITHIN THE WORK LIMITS SHOWN UNLESS SPECIFICALLY IDENTIFIED TO REMAIN. ITEMS TO BE REMOVED INCLUDE BUT ARE NOT LIMITED TO: CONCRETE, PAVEMENT, LIGHTING, UNDER GROUND PIPING, POLES, STAIRS, FENCES, WALLS, BUILDING, FOUNDATION, TREES AND LANDSCAPING.
13. COORDINATE ALL WORK WITHIN THE PUBLIC RIGHT OF WAYS WITH THE TOWN OF DURHAM AND THE NEW HAMPSHIRE DEPARTMENT OF TRANSPORTATION.
14. REMOVE TREES AND BRUSH AS REQUIRED FOR COMPLETION OF WORK. CONTRACTOR SHALL GRUB AND REMOVE ALL STUMPS WITHIN LIMITS OF WORK AND DISPOSE OF OFF SITE IN ACCORDANCE WITH FEDERAL, STATE, AND LOCAL LAWS AND REGULATIONS.
15. CONTRACTOR SHALL PROTECT ALL PROPERTY MONUMENTATION THROUGHOUT DEMOLITION AND CONSTRUCTION OPERATIONS. SHOULD ANY MONUMENTATION BE DISTURBED BY THE CONTRACTOR, HE SHALL EMPLOY A LICENSED SURVEYOR TO REPLACE IT.
16. PROVIDE INLET PROTECTION BARRIERS AT ALL CATCH BASINS WITHIN CONSTRUCTION LIMITS AND MAINTAIN FOR THE DURATION OF THE PROJECT. INLET PROTECTION BARRIERS SHALL BE "HIGH FLOW SILT SACK" BY ACF ENVIRONMENTAL OR APPROVED EQUAL. INSPECT BARRIERS WEEKLY AND AFTER EACH RAIN OF 0.25 INCHES OR GREATER. CONTRACTOR SHALL COMPLETE A MAINTENANCE INSPECTION REPORT AFTER EACH INSPECTION. SEDIMENT DEPOSITS SHALL BE REMOVED AFTER EACH STORM EVENT OR MORE OFTEN IF THE FABRIC BECOMES CLOGGED. REPLACE ALL FILTERS WHEN SEDIMENT IS ONE THIRD THE FILTER'S HEIGHT.
17. THE CONTRACTOR SHALL PHASE DEMOLITION AND CONSTRUCTION AS REQUIRED TO PROVIDE CONTINUOUS SERVICE TO EXISTING HOMES THROUGHOUT THE CONSTRUCTION PERIOD. EXISTING HOME SERVICES INCLUDE, BUT ARE NOT LIMITED TO ELECTRICAL, COMMUNICATION, FIRE PROTECTION, DOMESTIC WATER AND SEWER SERVICES. TEMPORARY SERVICES, IF REQUIRED, SHALL COMPLY WITH ALL FEDERAL, STATE, LOCAL AND UTILITY COMPANY STANDARDS. CONTRACTOR SHALL PROVIDE DETAILED CONSTRUCTION SCHEDULE TO OWNER PRIOR TO ANY DEMOLITION/CONSTRUCTION ACTIVITIES.
18. EROSION CONTROL MEASURES SHALL BE INSTALLED PRIOR TO THE START OF ANY CLEARING OR DEMOLITION ACTIVITIES.
19. THE CONTRACTOR SHALL PAY ALL COSTS NECESSARY FOR TEMPORARY PARTITIONING, BARRICADING, FENCING, SECURITY AND SAFETY DEVICES REQUIRED FOR THE MAINTENANCE OF A CLEAN AND SAFE CONSTRUCTION SITE.
20. SAWCUT AND REMOVE PAVEMENT AND CONSTRUCT PAVEMENT TRENCH PATCH FOR ALL UTILITIES TO BE REMOVED AND PROPOSED UTILITIES LOCATED IN EXISTING PAVEMENT AREAS TO REMAIN.
21. THE CONTRACTOR SHALL REMOVE AND SALVAGE EXISTING GRANITE CURB FOR REUSE.
22. THE EXISTING BUILDINGS SHALL BE REMOVED BY OTHERS DOWN TO THE EXISTING FOUNDATIONS. THE BUILDING FOUNDATION SHALL BE REMOVED BY THE SITE CONTRACTOR.

SPECIAL NOTES:

1. PRESERVATION OF NATURAL FEATURES AND AMENITIES. GRADING AND CLEARING SHOULD BE MINIMIZED SO AS TO AVOID CREATING UNDESIRABLE EROSION OR INTERRUPTION OF NATURAL DRAINAGE WAYS. PARTICULAR ATTENTION SHOULD BE GIVEN TO NATURAL FEATURES SUITABLE AS BUFFER STRIPS. THE APPLICANT SHALL USE CONSTRUCTION METHODS WHICH CAUSE THE LEAST DISTURBANCE TO THE ENVIRONMENT POSSIBLE. CLEARING LIMITS SHALL BE ESTABLISHED IN THE FIELD AND APPROVED BY THE TREE WARDEN PRIOR TO COMMENCEMENT OF CLEARING.
2. NO CUT TREES, STUMPS, DEBRIS, JUNK, RUBBISH, OR OTHER WASTE MATERIALS SHALL BE BURIED IN THE LAND, OR LEFT OR DEPOSITED ON SITE AT THE TIME OF THE CERTIFICATE OF OCCUPANCY OR AFTER THAT.
3. ACCESS INTO THE SITE FOR FIRE APPARATUS MUST BE MAINTAINED AT ALL TIMES DURING THE CONSTRUCTION PROCESS. THIS IS THE SOLE RESPONSIBILITY OF THE APPLICANT/DEVELOPER TO MAINTAIN THIS ACCESS. PLEASE CONTACT THE FIRE DEPARTMENT AT 868-5531 WITH ANY QUESTIONS ABOUT ACCESS REQUIREMENTS.
4. THE VEGETATIVE BUFFER AS SHOWN ALONG THE FRONT OF ROUTE 155A/MAST ROAD SHALL BE PRESERVED IN PERPETUITY EXCEPT FOR REMOVAL OF ANY DEAD, DISEASED, OR INVASIVE VEGETATION.
5. CONSTRUCTION/CLEARING LIMITS SHALL BE MARKED BY SILT SOCK/EROSION CONTROL BERM, ORANGE CONSTRUCTION FENCE, OR TEMPORARY CHAINLINK FENCE AS APPROPRIATE.

LINE	BEARING	DISTANCE
L1	S 55°19'41" W	108.56'
L2	S 64°28'55" W	186.83'
L3	S 61°19'46" W	98.18'
L4	S 58°48'12" W	161.39'
L5	S 49°15'08" W	289.03'
L6	S 47°14'43" W	51.59'
L7	S 44°22'09" W	36.59'
L8	S 43°47'57" W	71.36'
L9	S 39°08'28" W	43.25'
L10	S 29°47'05" E	50.02'
L11	S 18°30'00" E	63.97'
L12	S 10°59'12" E	69.63'
L13	S 44°27'29" E	29.99'
L14	S 38°54'14" E	42.71'
L15	S 42°59'02" E	43.84'
L16	S 40°15'32" E	28.19'
L17	S 39°33'36" E	43.12'
L18	S 41°55'58" E	23.75'
L19	N 67°48'13" E	125.48'

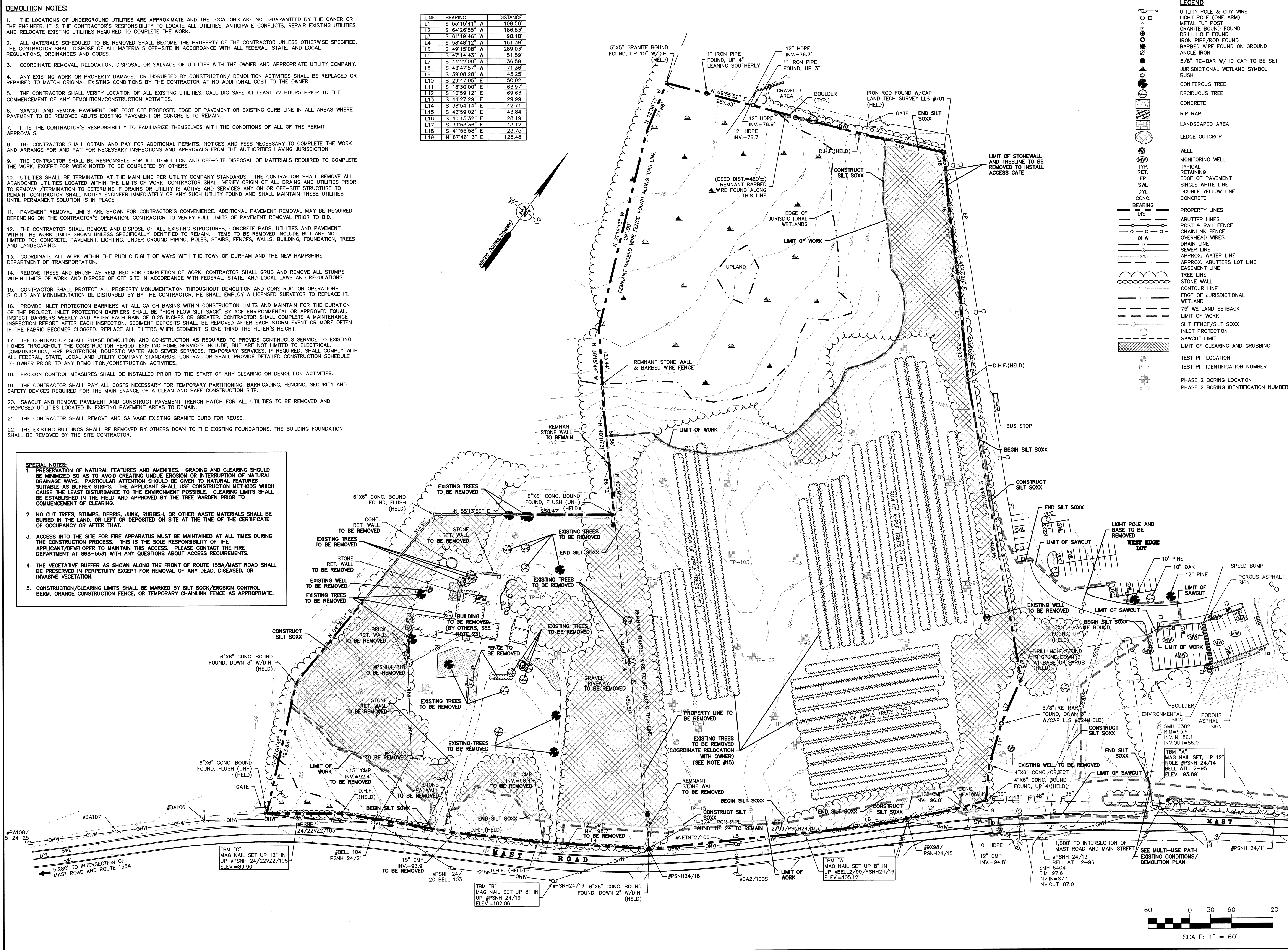

LEGEND

- UTILITY POLE & GUY WIRE
- LIGHT POLE (ONE ARM)
- METAL "U" POST
- GRANITE BOUND FOUND
- DRILL HOLE FOUND
- IRON PIPE/ROD FOUND
- BARBED WIRE FOUND ON GROUND
- ANGLE IRON
- 5/8" RE-BAR W/ ID CAP TO BE SET
- JURISDICTIONAL WETLAND SYMBOL
- BUSH
- CONIFEROUS TREE
- DECIDUOUS TREE
- CONCRETE
- RIP RAP
- LANDSCAPED AREA
- LEDGE OUTCROP
- WELL
- MONITORING WELL
- TYP. RET.
- EP
- SWL
- DYL
- CONC.

BEARING

DIST

ABUTTER LINES

POST & RAIL FENCE

CHAINLINK FENCE

OVERHEAD WIRES

DRAIN LINE

SEWER LINE

APPROX. WATER LINE

APPROX. ABUTTERS LOT LINE

EASEMENT LINE

TREE LINE

STONE WALL

CONTOUR LINE

EDGE OF JURISDICTIONAL WETLAND

75' WETLAND SETBACK

LIMIT OF WORK

SILT FENCE/SILT SOXX

INLET PROTECTION

SAWCUT LIMIT

LIMIT OF CLEARING AND GRUBBING

TEST PIT LOCATION

TEST PIT IDENTIFICATION NUMBER

PHASE 2 BORING LOCATION

PHASE 2 BORING IDENTIFICATION NUMBER

Tighe & Bond
 Consulting Engineers
 177 Corporate Drive
 Portsmouth, NH 03801
 www.tighebond.com

100 YEARS
 1911-2011

STATE OF NEW HAMPSHIRE
 BRADLEE MEZQUITA
 No. 08830

Peak Campus Development, LLC
 The Lodges at West Edge
 Durham, NH

Mark	Date	Description
E	6/21/13	REVISED FOR FINAL APPROVAL
D	6/11/13	ISSUED FOR BUILDING PERMIT
C	11/1/12	REVISED FOR PB SUBMISSION
B	9/26/12	REVISED FOR PB SUBMISSION
A	8/22/12	PB SUBMISSION

PROJECT NO: P0637
 FILE: P0637_DEMO.dwg
 DRAWN BY: KAM/SLK1
 CHECKED: JMP2
 APPROVED BY: GMM

DEMOLITION PLAN
 SCALE: AS SHOWN
 SHEET 3