

© CIVIL CONSULTANTS
CIVIL CONSULTANTS
 Engineers
 Planners
 Surveyors
 P.O. Box 100
 South Berwick
 Maine
 03908
 207-384-2550
 www.civcon.com

NO.	REVISIONS	INT.	DATE
1			

RECORD OWNER:
 COUNTY LINE HOLDINGS, LLC.
 OWNER ADDRESS:
 8 LITTLE JOHN ROAD
 DURHAM, NH 03824

**SHARED DRIVEWAY PLAN
 RESIDENTIAL SUBDIVISION**
EDGEWOOD ROAD EXT., DURHAM, NEW HAMPSHIRE
 PREPARED FOR:
 COUNTY LINE HOLDINGS, LLC.
 CLIENT ADDRESS: JOHN FARRELL, 8 LITTLE JOHN RD, DURHAM, NH 03824

DATE: 7/23/2015
 DRAWN BY: NJR
 CHECKED BY: GRA
 APPROVED BY: NJR

**SHARED DRIVEWAY AND
 EXISTING DRIVE
 IMPROVEMENT PLAN**

PROJECT NO: 14-299.00

C1
 SHEET: 1 OF 2

SEE REFERENCE PLAN 1 FOR ALL
 SUBDIVISION INFORMATION, ABUTTER
 INFORMATION, EASEMENT DESCRIPTIONS,
 METES AND BOUNDS, AND LOT
 DESIGNATIONS. THIS PLAN IS INTENDED
 TO INDICATE THE PROPOSED ROAD
 IMPROVEMENTS AND PRIVATE DRIVE
 DETAILS ONLY.

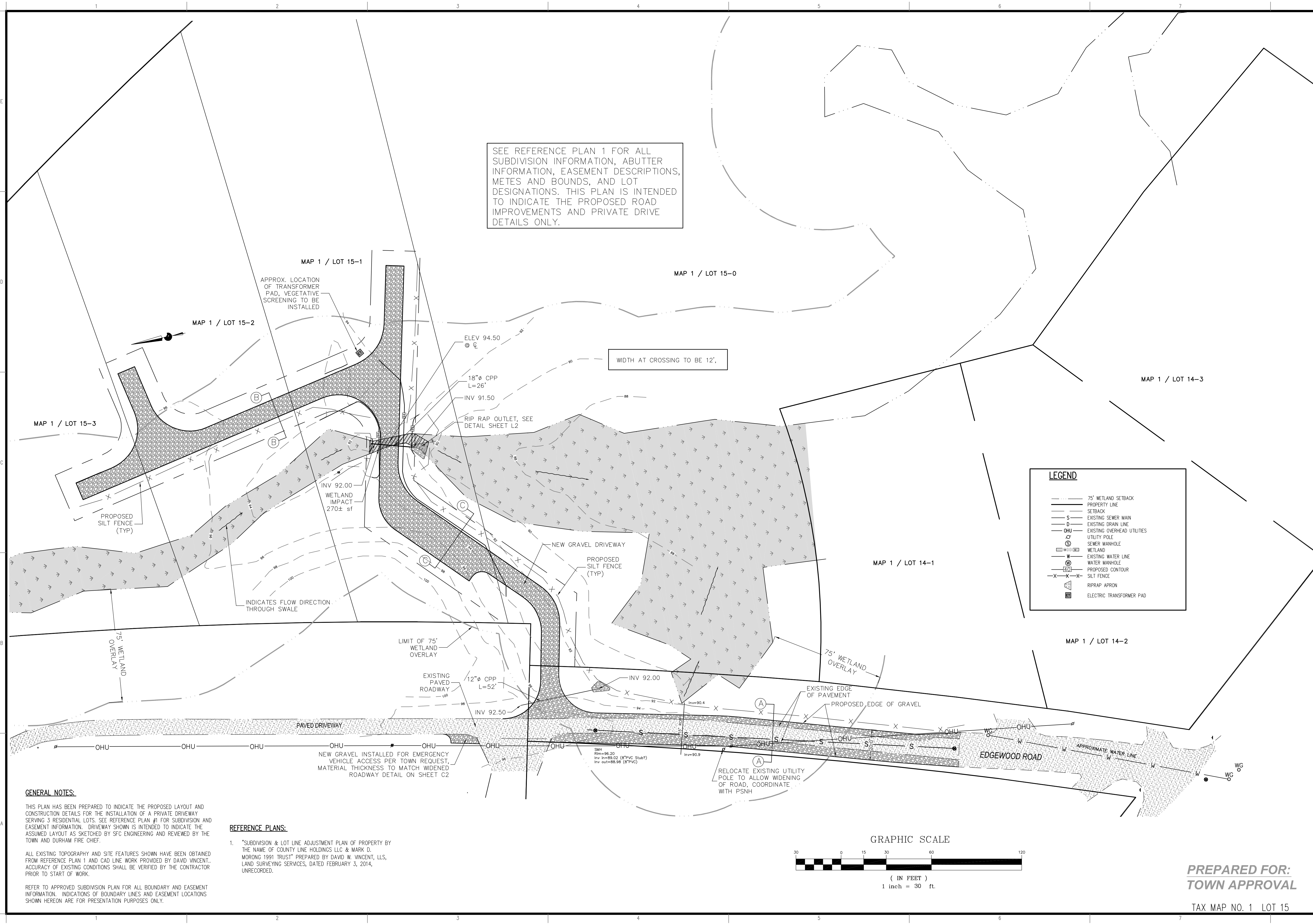

GENERAL NOTES:

THIS PLAN HAS BEEN PREPARED TO INDICATE THE PROPOSED LAYOUT AND CONSTRUCTION DETAILS FOR THE INSTALLATION OF A PRIVATE DRIVEWAY SERVING 3 RESIDENTIAL LOTS. SEE REFERENCE PLAN #1 FOR SUBDIVISION AND EASEMENT INFORMATION. DRIVEWAY SHOWN IS INTENDED TO INDICATE THE ASSUMED LAYOUT AS SKETCHED BY SFC ENGINEERING AND REVIEWED BY THE TOWN AND DURHAM FIRE CHIEF.

REFER TO APPROVED SUBDIVISION PLAN FOR ALL BOUNDARY AND EASEMENT INFORMATION. INDICATIONS OF BOUNDARY LINES AND EASEMENT LOCATIONS SHOWN HEREON ARE FOR PRESENTATION PURPOSES ONLY.

REFERENCE PLANS:

- "SUBDIVISION & LOT LINE ADJUSTMENT PLAN OF PROPERTY BY THE NAME OF COUNTY LINE HOLDINGS LLC & MARK D. MORONG 1991 TRUST" PREPARED BY DAVID W. VINCENT, LLS, LAND SURVEYING SERVICES, DATED FEBRUARY 3, 2014, UNRECORDED.

SEEDING MIXTURE AND SCHEDULE:

SPREAD TOPSOIL UNIFORMLY 6" DEEP OVER AREAS TO BE RECLAIMED. THE FOLLOWING SEED MIXTURE SHALL BE USED:

LAWNS:

KENTUCKY BLUEGRASS	0.46 LBS./1000 S.F.
CREeping RED FESCUE	0.46 LBS./1000 S.F.
PERENNIAL RYE GRASS	0.11 LBS./1000 S.F.
TOTAL	1.03 LBS./1000 S.F.

APPLY LIME AND FERTILIZER AS SPECIFIED UNDER THE EROSION AND SEDIMENTATION CONTROL NOTES. WORK INTO THE TOP (4) INCHES OF SOIL PRIOR TO SEEDING. AFTER SEEDING, APPLY MULCH HAY AS SPECIFIED. ON FLAT AREAS AND NOT EXPOSED TO WIND, THE MULCH WILL BE ANCHORED BY NETTING DOWN. IN OTHER AREAS, JUTE NETTING SHALL BE USED FOR ANCHORAGE. THE ABOVE SEEDING SCHEDULE IS APPLICABLE IF SEEDING DURING THE GROWING SEASON (APRIL 15 TO JUNE 15 AND AUGUST 30 TO SEPTEMBER 30). BETWEEN JUNE 15 AND AUGUST 30, SEEDING WILL BE DELAYED UNTIL AUGUST 30. IF SOIL IS DISTURBED BETWEEN OCTOBER 1 AND NOVEMBER 1, DELAY SEEDING UNTIL NOVEMBER 1. AFTER NOVEMBER 1 AND BEFORE A SNOW COVER FORMS, THE SAME PROCEDURE WILL BE FOLLOWED EXCEPT THE SEED RATE WILL BE DOUBLED. AFTER SNOW COVER AND BEFORE APRIL 15, SEEDING WILL BE DELAYED UNTIL APRIL 15. HAY MULCH WILL BE APPLIED AT A RATE OF 150 LBS./1000 SQUARE FEET. THIS WILL BE ANCHORED BY NON-ASPHALTIC TACKIFIER SPRAYED ON LAWNS AND JUTE NETTING IN DRAINAGE WAYS AND OTHER AREAS.

EROSION AND SEDIMENT CONTROL PRACTICES

- NO SOIL SHALL BE DISTURBED DURING THE PERIOD OF MARCH 1 THROUGH APRIL 15, NOR DURING ANY OTHER PERIOD WHEN SOILS ARE SATURATED DUE TO RAIN OR SNOW MELT.
- DISTURBED SOILS SHALL BE STABILIZED WITHIN ONE (1) WEEK FROM THE TIME IT WAS LAST ACTIVELY WORKED USING TEMPORARY OR PERMANENT MEASURES SUCH AS PLACEMENT OF RIPRAP, MULCH OR EROSION CONTROL BLANKET, OR OTHER COMPARABLE MEASURES.
- HAY OR STRAW MULCH SHALL BE APPLIED AT A RATE OF AT LEAST ONE (1) BALE PER 500 SQUARE FEET (1-2 TONS PER ACRE).
- IF MULCH IS LIKELY TO BE REMOVED DUE TO STEEP SLOPES OR WIND, IT SHALL BE ANCHORED WITH NETTING, PEG OR TWINE, OR OTHER SUITABLE METHOD AND SHALL BE MAINTAINED UNTIL A CATCH OF VEGETATION IS ESTABLISHED OVER THE ENTIRE DISTURBED AREA.
- IN ADDITION TO PLACEMENT OF RIPRAP, MULCH OR EROSION CONTROL BLANKETS, ADDITIONAL STEPS SHALL BE TAKEN WHERE NECESSARY IN ORDER TO PREVENT SEDIMENTATION OF THE WATER. EVIDENCE OF SEDIMENTATION INCLUDES VISIBLE GULLY EROSION, DISCOLORATION OF WATER BY SUSPENDED PARTICLES AND SLUMPING OF BANKS, SILT FENCES, STAKED HAY BALES AND OTHER SEDIMENTATION CONTROL MEASURES, WHERE PLANNED FOR, SHALL BE IN PLACE PRIOR TO COMMENCEMENT OF WORK, BUT SHALL ALSO BE INSTALLED WHEREVER NECESSARY DUE TO SEDIMENTATION.
- MULCH OR OTHER TEMPORARY MEASURES SHALL BE MAINTAINED UNTIL THE SITE IS PERMANENTLY STABILIZED WITH VEGETATION OR OTHER PERMANENT CONTROL MEASURES AFTER WHICH TEMPORARY MEASURES WILL BE REMOVED.
- PERMANENT RE-VEGETATION OF ALL DISTURBED AREAS, USING NATIVE PLANT MATERIAL WHEN POSSIBLE, SHALL OCCUR WITHIN 30 DAYS FROM THE TIME THE AREAS WERE LAST ACTIVELY WORKED, OR FOR FALL AND WINTER ACTIVITIES, BY JUNE 15, EXCEPT WHERE PRECLUDED BY THE TYPE OF ACTIVITY (E.G. RIPRAP, ROAD SURFACES, ETC.). THE VEGETATIVE COVER SHALL BE MAINTAINED.
- DISPOSAL OF COLLECTED DEBRIS MUST BE IN CONFORMANCE WITH MAINE SOLID WASTE LAW, TITLE 38 MRSA SECTION 1301 ET. SEQ.
- LIME AND FERTILIZER APPLICATION RATES SHALL NOT EXCEED THE FOLLOWING:
 GROUND LIMESTONE: 3 TONS/ACRE (130 LBS./1000 S.F.)
 FERTILIZER, 10-10-10 OF EQUIVALENT: 600 LBS./ACRE (14 LBS./1000 S.F.)
 FERTILIZER SHALL NOT BE APPLIED BEFORE START OF THE GROWING SEASON NOR AFTER SEPTEMBER 30. FERTILIZED AREAS SHALL BE MULCHED TO REDUCE OFF-SITE TRANSPORT OF NUTRIENTS UNTIL USED BY VEGETATIVE GROWTH.

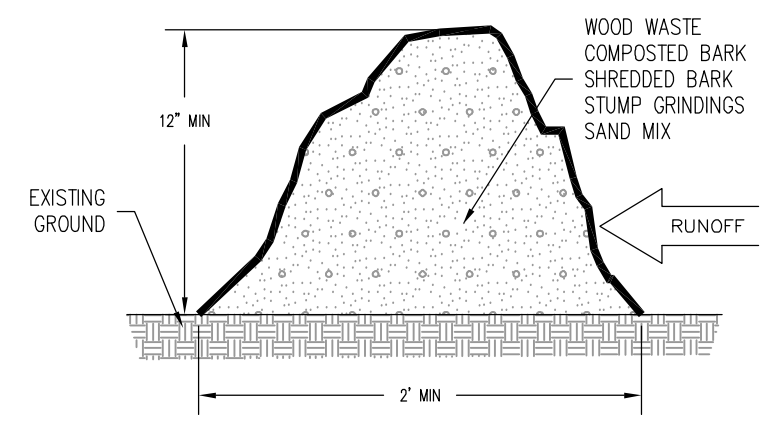

NOTES:

- THIS BERM MAY BE USED IN PLACE OF FILTER FENCE WHERE APPLICABLE. THE MIXTURE OF THE BERM MATERIAL NEEDS TO BE A WELL-GRADED BLEND OF ORGANIC & MINERAL SUBSTANCE CONFORMING TO THE FOLLOWING STANDARDS:
 ORGANIC MATTER CONTENT: BETWEEN 80% AND 100%
 MOISTURE CONTENT: 30%-60%
 PH: BETWEEN 5.0 AND 8.0
 PARTICLE SIZE BY WEIGHT SHALL BE 100% PASSING A 5" SCREEN AND A MINIMUM OF 70% MAXIMUM OF 85% PASSING A 0.75" SCREEN. LARGE PORTION OF SILTS, CLAYS OR FINE SANDS ARE NOT ACCEPTABLE MIX.
- THE BERM SHALL BE PLACED ALONG A RELATIVELY LEVEL CONTOUR WHEREVER POSSIBLE. THE EXISTING SURFACE MUST BE SCoured AND THE MIXTURE KEVED IN LIKE ANY OTHER SEDIMENT CONTROL MEASURE.

FILTER BERM DETAIL
NOT TO SCALE

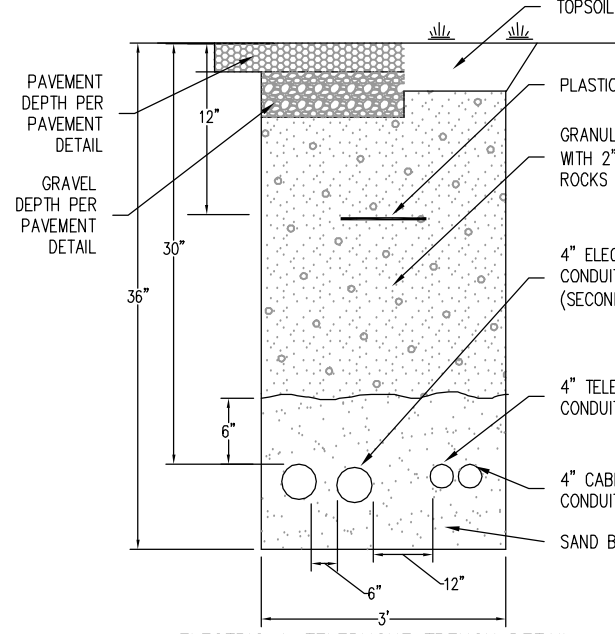

ELECTRIC & TELEPHONE TRENCH DETAIL
NOT TO SCALE

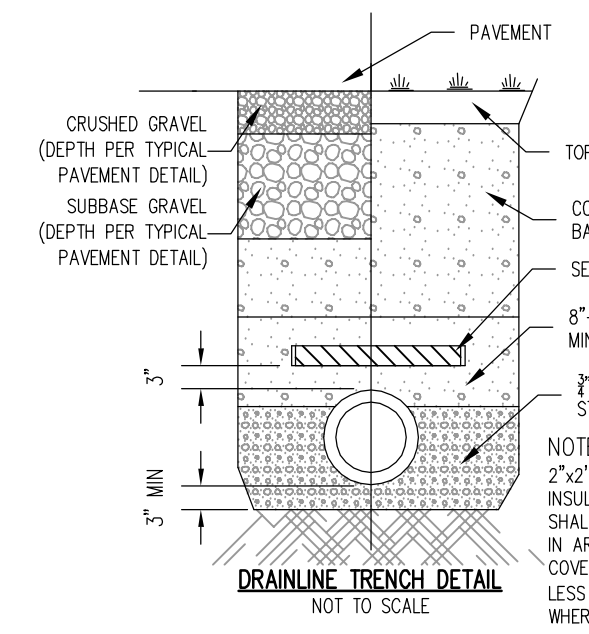

DRAINLINE TRENCH DETAIL
NOT TO SCALE

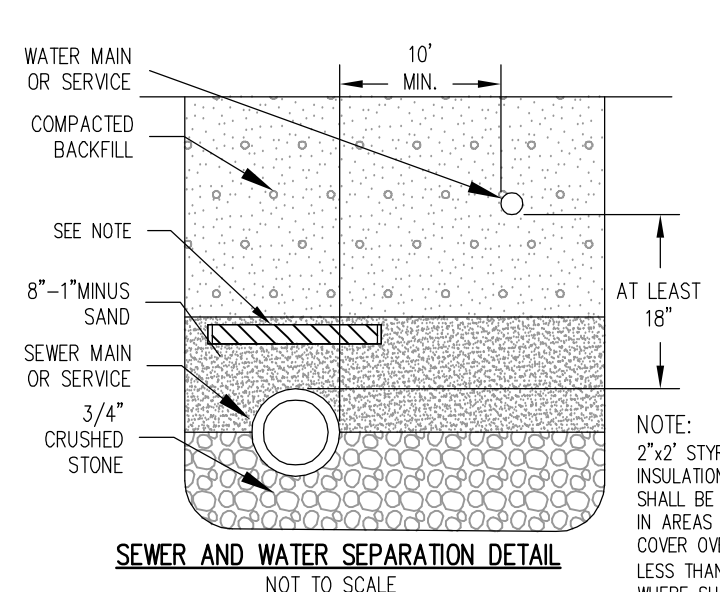

SEWER AND WATER SEPARATION DETAIL
NOT TO SCALE

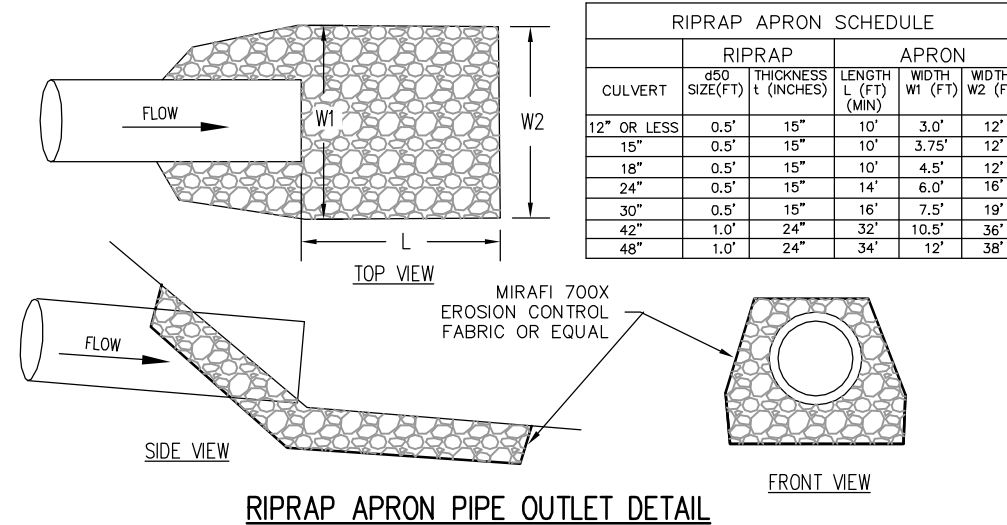

RIPRAP APRON PIPE OUTLET DETAIL
NOT TO SCALE

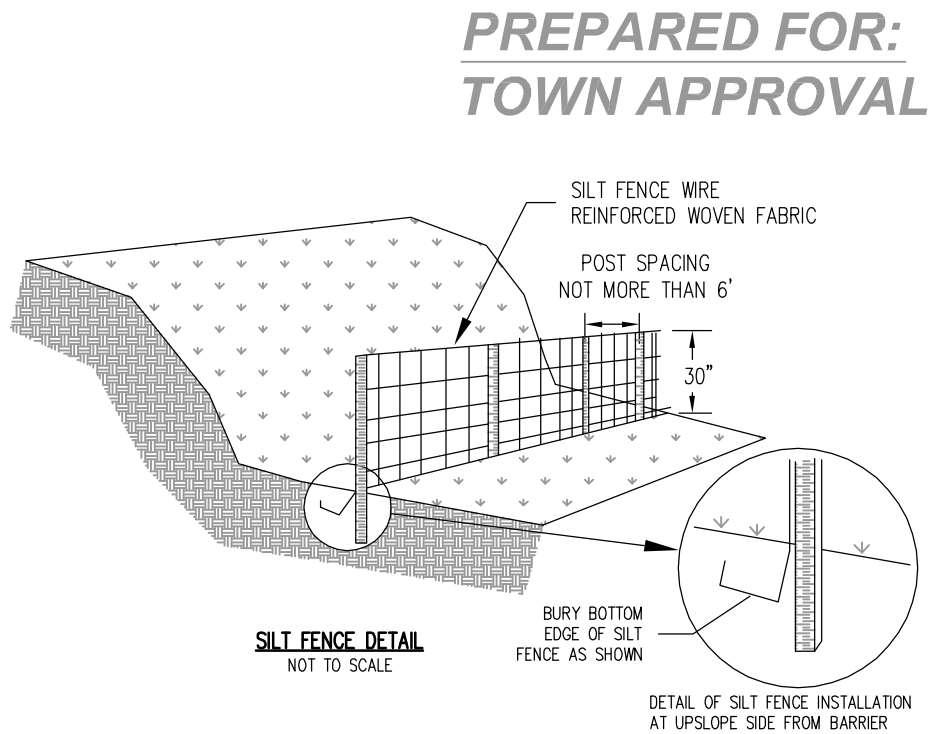

SILT FENCE DETAIL
NOT TO SCALE

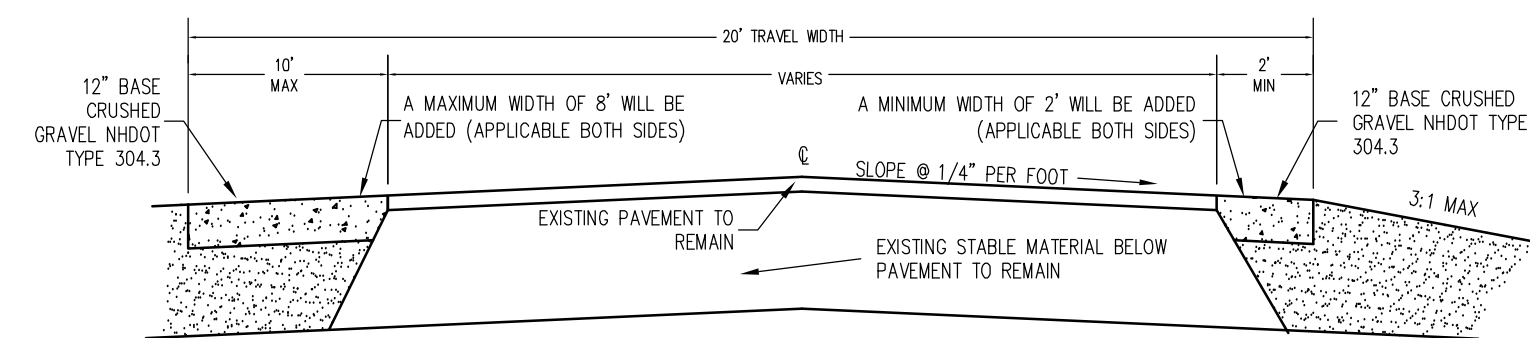

A-A TYPICAL EXPANDED ROAD SECTION
NOT TO SCALE

THIS DETAIL REPRESENTATIVE OF ASSUMED MODIFICATION TO EXISTING EDGEWOOD DRIVE ROADWAY TO CREATE A 20' WIDE TRAVEL WAY AS DICTATED BY THE TOWN PLANNER AND MEETING THE DESIGN INTENT OF SFC ENGINEERS IN CONJUNCTION WITH THE TOWN OF DURHAM FIRE DEPARTMENT

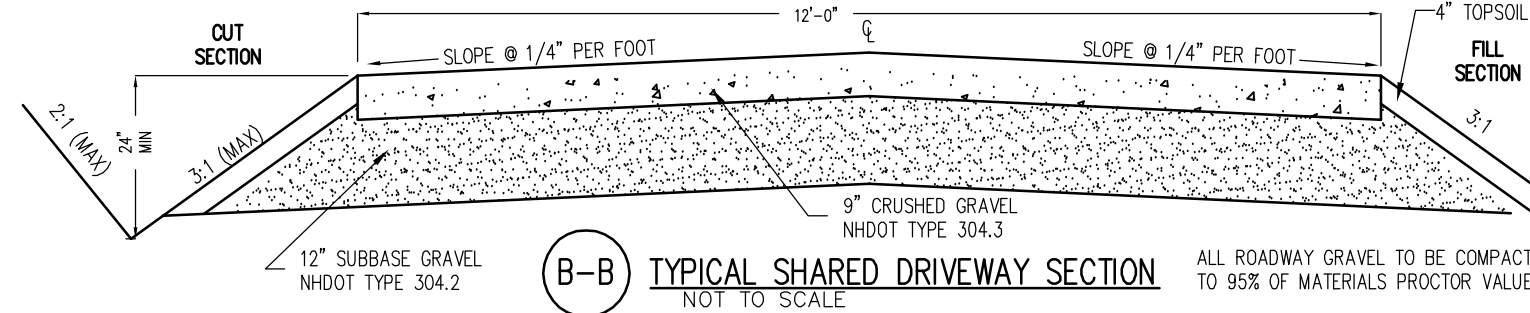

B-B TYPICAL SHARED DRIVEWAY SECTION
NOT TO SCALE

ALL ROADWAY GRAVEL TO BE COMPACTED TO 95% OF MATERIALS PROCTOR VALUE

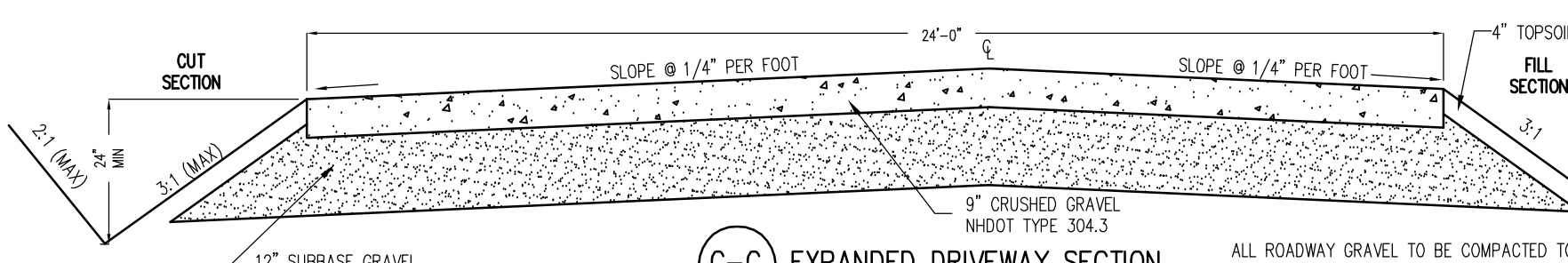

C-C EXPANDED DRIVEWAY SECTION
NOT TO SCALE

ALL ROADWAY GRAVEL TO BE COMPACTED TO 95% OF MATERIALS PROCTOR VALUE

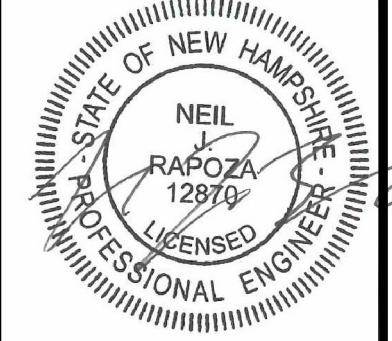

© CIVIL CONSULTANTS
CIVIL CONSULTANTS
 Engineers
 Planners
 Surveyors
 P.O. Box 100
 South Berwick
 Maine
 03908
 207-384-2550
 www.civcon.com

NO.	REVISIONS	INT.	DATE
1			

RECORD OWNER:
 COUNTY LINE HOLDINGS, LLC.
 OWNER ADDRESS:
 8 LITTLE JOHN ROAD
 DURHAM, NH 03824

SHARED DRIVEWAY PLAN
RESIDENTIAL SUBDIVISION
EDGEWOOD ROAD EXT., DURHAM, NEW HAMPSHIRE
 PREPARED FOR:
 COUNTY LINE HOLDINGS, LLC.
 CLIENT ADDRESS: JOHN FARRELL, 8 LITTLE JOHN RD, DURHAM, NH 03824

DATE: 7/23/2015
 DRAWN BY: NJR
 CHECKED BY: GRA
 APPROVED BY: NJR

NOTES AND DETAILS

PROJECT NO: 14-299.00

C2

SHEET: 2 OF 2

TAX MAP NO. 1 LOT 15