

LOCATION PLAN

- NOTES**
- RANDOM TRAVERSE ERROR OF CLOSURE IS LESS THAN 1 PART IN 10,000.
 - REFERENCE PLANS:
 - "TEMPORARY SHOOTING RANGE PREPARED FOR TOWN OF DURHAM POLICE DEPARTMENT" BY MJS ENGINEERING, P.C., DATED 2/16/15
 - "EXISTING CONDITIONS PLAN PREPARED FOR THE RIVERWOODS GROUP", BY ATLANTIC SURVEY COMPANY, DATED APRIL 2017
 - "BASE MAP FOR THE TOWN OF DURHAM-NEW HAMPSHIRE" BY DOUCET SURVEY DATED JUNE 22, 1996 ON FILE AT THE TOWN OF DURHAM PUBLIC WORKS.
 - "SUBDIVISION OF LAND PREPARED FOR ROCKINGHAM PROPERTIES 1 LTD LOCATED AT ROUTE 108 & STONE QUARRY DRIVE, DURHAM, NH BY ATLANTIC SURVEY CO, LLC DATED DEC., 2001 S.C.R.D. PLAN No. 74-62.
 - The parcel shown as "Parcel 1" will be conveyed to Riverwoods Durham by the Town of Durham at an or even date with the recording of this Lot Line Adjustment Plan and the parcel will be consolidated with Lots 8-1 through 8-15.
 - The parcel shown as "Parcel 2" will be conveyed to the Town of Durham by Riverwoods Durham at an or even date with the recording of this Lot Line Adjustment Plan and the parcel will be consolidated with Lot 11-12.
 - The parcel shown as "Parcel 3" will be conveyed to the Riverwoods Durham by Land Options, LLC at an or even date with the recording of this Lot Line Adjustment Plan and the parcel will be consolidated with Lots 8-1 through 8-15.
 - Approval of this Lot Line Adjustment Plan does not guarantee that final approval for the Site Plan will be granted.

DATE: APRIL 30, 2018

DRAWN BY: _____ RMB

APPROVED BY: _____ JKC, AF

DRAWING FILE: _____ 4836SITE.DWG

SCALE: 1" = 50'

OWNERS:

MAP 11 LOTS 8-1 TO 8-15
ROCKINGHAM PROPERTIES 1, LTD
 S.C.R.D. BOOK 1780 PAGE 450
 S.C.R.D. BOOK 1879 PAGE 132
 P.O. BOX 423
 BELMONT, MA 02178

LOT 8-0
LAND OPTIONS, LLC
 S.C.R.D. BOOK 4484 PAGE 508
 96 CLIFF ROAD
 PORTSMOUTH, NH 03801

LOT 11-12
TOWN OF DURHAM
 S.C.R.D. BOOK 1827 PAGE 501
 15 NEWMARKET ROAD
 DURHAM, NH 03824

APPLICANT:

THE RIVERWOODS GROUP
 7 RIVERWOODS DRIVE
 EXETER, NH 03833

PROJECT:

RIVERWOODS DURHAM
STONE QUARRY DRIVE
DURHAM, NH

TITLE:

Lot Line Adjustment Plan
 PREPARED FOR
THE RIVERWOODS GROUP
 LOCATED AT
STONE QUARRY DR & RTE 108
DURHAM, NH

SHEET NUMBER:

G - 1.0

REVISED LOT AREAS

MAP	LOT	OLD LOT AREA	NEW LOT AREA
11	8-0	97,547 s.f.	87,342 s.f.
11	8-1 THROUGH 8-15	481,713 s.f.	491,918 s.f.
11	12	443,912 s.f.	443,912 s.f.

- LEGEND**
- 5/8" IRON ROD w/ID CAP TO BE SET
 - ⊙ DRILL HOLE FOUND
 - FOUND GRANITE BOUND
 - n/f NOW OR FORMERLY
 - S.C.R.D. STRAFFORD COUNTY REGISTRY OF DEEDS
 - EXISTING HIGHWAY FENCE
 - ⋯ STONE WALL

FINAL APPROVAL FOR LOT LINE ADJUSTMENT ONLY
 CERTIFIED BY MICHAEL BEHRENDT, TOWN PLANNER
 CERTIFIED _____
 DATE _____

ATLANTIC SURVEY COMPANY
 25 Nute Road, Dover, New Hampshire 03820

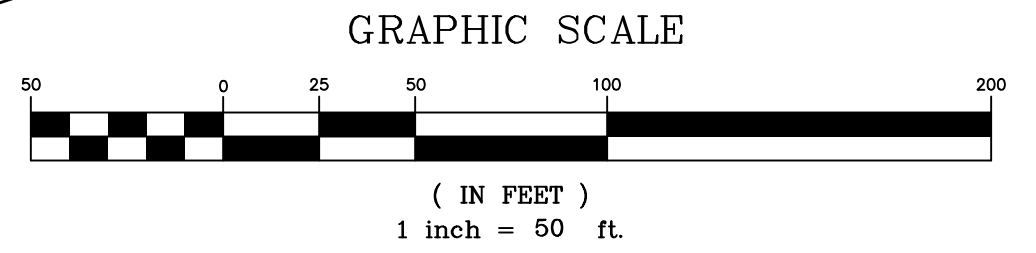

n/f
 Town of Durham
 15 Newmarket Road
 Durham, NH 03824
 Tax Map 11, Lot 12
 S.C.R.D. 1827/501
 EVEN LAND SWAP

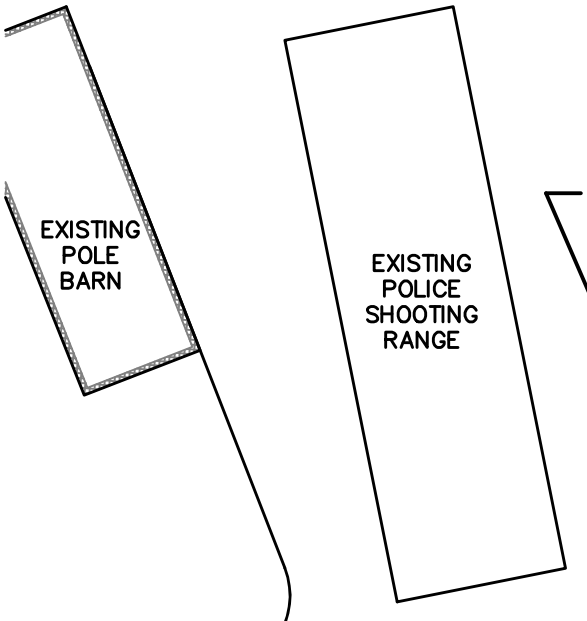

other land of
 Rockingham Properties 1, LTD
 PO Box 423
 Belmont, MA 02178
 Tax Map 11, Lot 8-2
 S.C.R.D. 1780/450

SUBJECT PARCEL
 Tax Map 11
 Lots 8-1 thru 8-15
 and Valbeth Lane
 R.O.W. MERGED
 481,713 S.F. OR 11.06 AC.
 PROPOSED AREA
 491,918 S.F. OR 11.29 AC.

LOT 8-0
 Previous Area
 97,547 S.F. OR 2.40 AC.
 Proposed Area
 87,342 S.F. OR 2.01 AC.

n/f
 Thomas B. & Mary E. Merrick
 7 Canney Road
 Durham, NH 03824
 Tax Map 10, Lot 11-5

other land of
 Rockingham Properties 1, LTD
 PO Box 423
 Belmont, MA 02178
 Tax Map 11, Lot 8-2
 S.C.R.D. 1780/450