

ZONING SUMMARY:
PROPERTY REFERENCE: MAP 11, LOTS 8-1 THROUGH 8-15 AND VALBETH LANE AND PORTION OF LOT 8-0
TOTAL SITE AREA: 492,247 S.F. OR 11.30 AC.
ZONING: OFFICE AND RESEARCH DISTRICT-ROUTE 108 (OR) WETLANDS CONSERVATION OVERLAY DISTRICT (WCO)
OWNER: ROCKINGHAM PROPERTIES 1, LTD
 PO BOX 423
 BELMONT, MA 02178

SETBACKS	REQ'D	PROVIDED
FRONT YARD	50' MIN.	50'
SIDE YARD	25' MIN.	25'
REAR YARD	25' MIN.	9'
WETLANDS BUFFER	75' MIN.	<75' CUP REQUESTED

PARKING:
 GARAGE 109 SPACES (INCL. 3 ADA SPACES)
 OUTSIDE 168 SPACES (INCL. 6 ADA SPACES)
 TOTAL 274 SPACES (9 ADA SPACES)

- REFERENCE PLANS:**
1. "EXISTING CONDITIONS PLAN, PREPARED FOR THE RIVERWOODS GROUP", PREPARED BY ATLANTIC SURVEY COMPANY, DATED APRIL 2017.
 2. "PLAN STONE QUARRY OFFICE PARK, DURHAM NH", PREPARED BY AMERICAN ENGINEERING CONSULTANTS, CORP., DATED SEPT. 04, 2002.
 3. "SUBDIVISION OF LAND, PREPARED FOR ROCKINGHAM PROPERTIES 1, LTD", PREPARED BY ATLANTIC SURVEY COMPANY, DATED DECEMBER 2001.

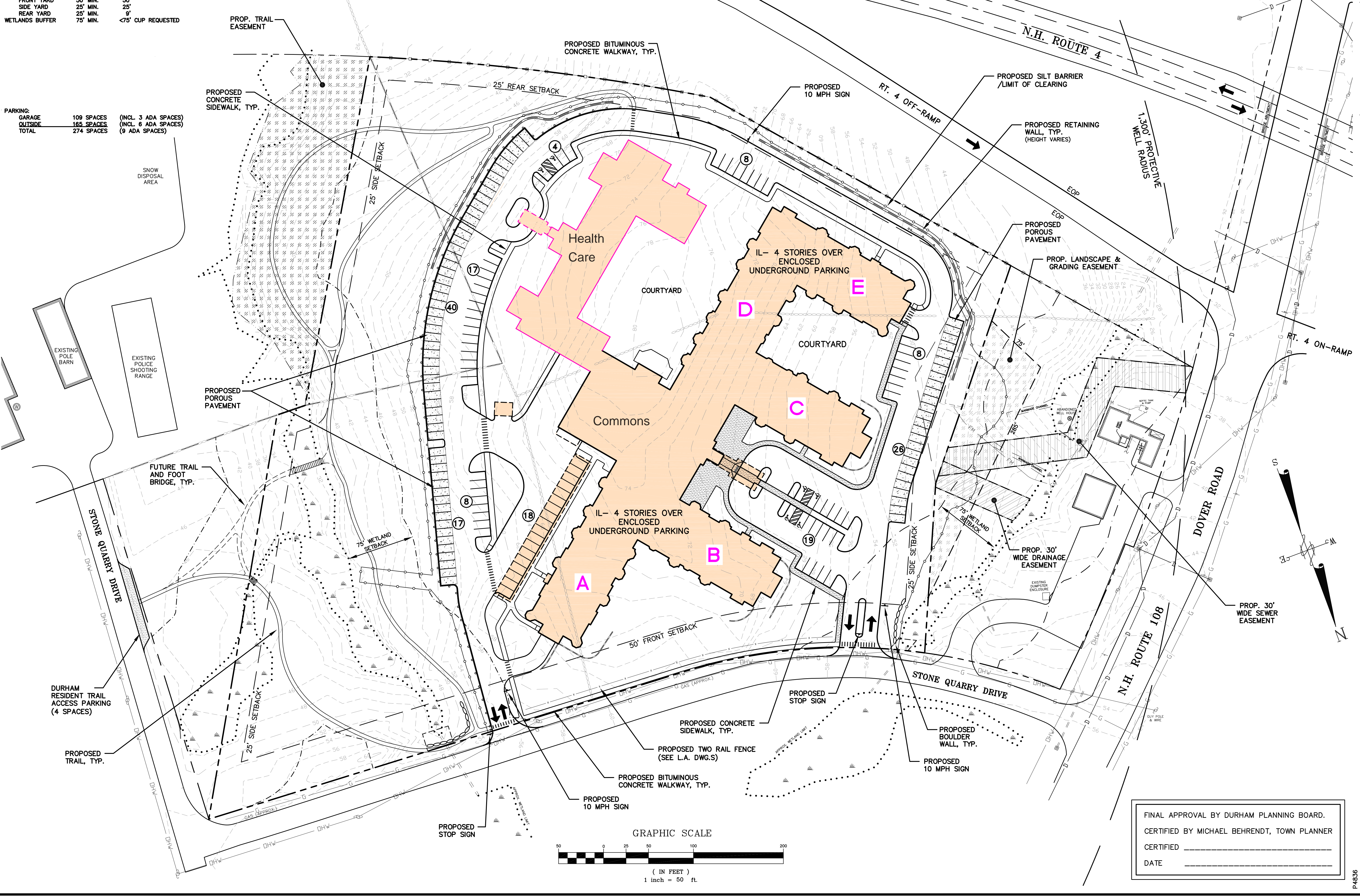

THIS DRAWING HAS NOT BEEN RELEASED FOR CONSTRUCTION
ISSUED FOR: REVIEW
ISSUE DATE: OCTOBER 3, 2017

NO.	DESCRIPTION	BY	DATE
0	INITIAL SUBMISSION	JKC	7/19/17
1	RE-SUBMISSION	JKC	9/25/17

DRAWN BY: RMB
APPROVED BY: JKJ
DRAWING FILE: 4836SITE.DWG

SCALE: 1" = 50'

LAND OWNER - SUBJECT PARCEL:
ROCKINGHAM PROPERTIES 1, LTD
 P.O. BOX 423
 BELMONT, MA 02178

APPLICANT:
THE RIVERWOODS GROUP
 7 RIVERWOODS DRIVE
 EXETER, NH 03833

PROJECT:
RIVERWOODS DURHAM
 STONE QUARRY DRIVE
 DURHAM, NH

TITLE:

SITE PLAN
SHEET NUMBER: C - 2.0

FINAL APPROVAL BY DURHAM PLANNING BOARD.
 CERTIFIED BY MICHAEL BEHRENDT, TOWN PLANNER
 CERTIFIED _____
 DATE _____

