



AMBIT ENGINEERING, INC.
Civil Engineers & Land Surveyors
200 Griffin Road - Unit 3
Portsmouth, N.H. 03801-7114
Tel (603) 430-9282
Fax (603) 430-2815

FEBRUARY 2007
PLAN 90-58
MAGNETIC
PER SCRD

**WETLAND IMPACT AREAS
(IN SQ. FT)**

	PROPOSED IMPACT	IMPACT TYPES
TIDAL WATERS WETLAND (E2US3N)	258	TEMPORARY
TIDAL BUFFER ZONE	1,988	PERMANENT
TOTAL	2,246 S.F.	

WETLAND NOTES:

1) HIGHEST OBSERVABLE TIDE LINE DELINEATED BY STEVEN D. RIKER, CWS ON 8/10/2017 IN ACCORDANCE WITH THE FOLLOWING STANDARDS:

- U.S. ARMY CORPS OF ENGINEERS WETLANDS DELINEATION MANUAL TECHNICAL REPORT Y-87-1 (JAN. 1987), AND REGIONAL SUPPLEMENT TO THE CORPS OF ENGINEERS WETLAND DELINEATION MANUAL: NORTHCENTRAL AND NORTHEAST REGION, VERSION 2.0, JANUARY 2012.
- FIELD INDICATORS OF HYDRIC SOILS IN THE UNITED STATES, VERSION 8.1, USDA-NRCS, 2017 AND (FOR DISTURBED SITES) FIELD INDICATORS FOR IDENTIFYING HYDRIC SOILS IN NEW ENGLAND, VERSION 4. NEWPCC WETLANDS WORK GROUP (2017).
- NATIONAL LIST OF PLANT SPECIES THAT OCCUR IN WETLANDS: NORTHEAST (REGION 1). USFWS (MAY 1988).
- CLASSIFICATION OF WETLANDS AND DEEPWATER HABITATS OF THE UNITED STATES. USFW MANUAL FWS/OBS-79/31 (1997).
- "IDENTIFICATION AND DOCUMENTATION OF VERNAL POOLS IN NEW HAMPSHIRE" (1997). NEW HAMPSHIRE FISH AND GAME DEPARTMENT.

2) WETLAND FLAGS WERE FIELD LOCATED BY AMBIT ENGINEERING, INC.

PLANTING NOTES:

SEED MIX:

BUFFER PLANTING AREA TO BE SEEDED WITH TICKLESEED/ROUGH BENTGRASS (AGROSTIS SCABRA), VIRGINIA WILD RYE (ELYMUS VIRGINIUS) AND LITTLE BLUESTEM (SCHIZACHYRIUM SCOPARIUM) SPREAD THROUGHOUT. SEE PYRAWALL AND ARMORMAX PLANTING SPECIFICATIONS.

SEED CAN BE OBTAINED FROM PIERSON NURSERIES INC (24 BUZZELL ROAD, BIDDEFORD, MAINE 04005; PHONE 207-499-2934)

LIVE STAKES:

NORTHERN ARROWWOOD (VIBURNUM RECOGNITUM)
SILKY DOGWOOD (CORNUS AMOMUM)
WILD RAISIN (VIBURNUM CASSINOIDES)
SPECKLED ALDER (ALNUS RUGOSA)

PLANT EVERY 4 FT ON CENTER IN THE PYRAWALL OFFSETS BETWEEN LIFTS.

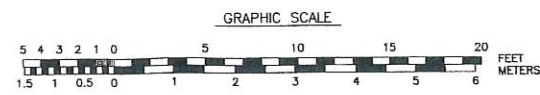
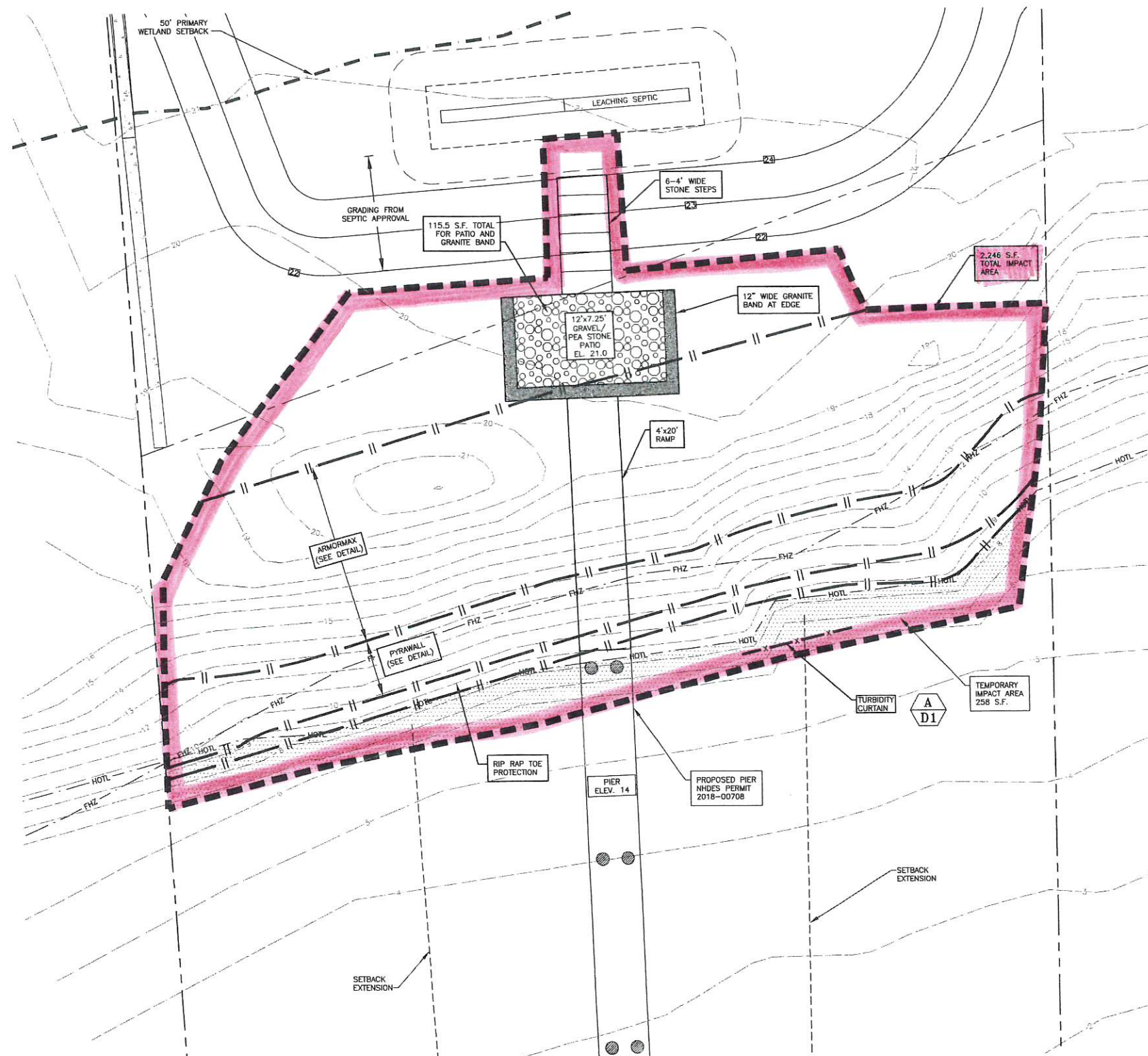

NOTES:

- PARCEL IS SHOWN ON THE TOWN OF DURHAM ASSESSOR'S MAP 12 AS LOT 1-8.
- OWNERS OF RECORD:
MANISHA P. HEIDERSCHIEDT
2010 REVOCABLE TRUST
MANISHA P. HEIDERSCHIEDT &
BENEDICT G. HEIDERSCHIEDT, TRUSTEES
21 CAVERNO DRIVE
LEE, NH 03861
4495/149
- A PORTION OF THE PARCEL IS IN A SPECIAL FLOOD HAZARD AREA AS SHOWN ON FIRM PANEL 33017C0340E. EFFECTIVE DATE SEPTEMBER 30, 2015.
- EXISTING LOT AREA:
11,794± SF
0.2708± ACRES
- PARCEL IS LOCATED IN RESIDENCE COASTAL (RC) ZONING DISTRICT AND IS SUBJECT TO THE SHORELAND PROTECTION OVERLAY DISTRICT.
- THE PURPOSE OF THIS PLAN IS TO SHOW THE LOCATION OF PROPOSED WALK AND PATIO AS WELL AS REPAIR TO AN EXISTING RETENTION ON TAX MAP 12 LOT 1-8.
- VERTICAL DATUM IS MEAN LOW LOW WATER LEVEL NAVD88. BASIS OF VERTICAL DATUM IS NH DOT BENCHMARK 133-0410.
- PROPERTY HAS 77' OF SHORE FRONTAGE.

**HEIDERSCHIEDT
RESIDENCE
32 CEDAR POINT ROAD
DURHAM, N.H.**

NO.	DESCRIPTION	DATE
2	REVISED PATIO LOCATION	2/13/19
1	REVISED PER ACF REVIEW	1/23/19
0	ISSUED FOR COMMENT	1/8/19

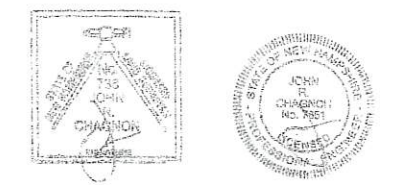

SCALE 1"=5' JANUARY 2019

**RETENTION
PERMIT PLAN**

C2

J:\0652\02500s\JN_2550\JN_2550\2552.16 Heiderscheidt 32 Cedar Point Road, Durham, NH\2017 Permitting\Plans & Specs\Site\2552.16 Revetment 2019.dwg, e2 permit

FEBRUARY 2007
 PLAN 90-58
 MAGNETIC
 PER SCRD

WETLAND IMPACT AREAS (IN SQ. FT)		
	PROPOSED IMPACT	IMPACT TYPES
TIDAL WATERS WETLAND (E2US3N)	258	TEMPORARY
TIDAL BUFFER ZONE	1,492	PERMANENT
TOTAL	1,750 S.F.	

WETLAND NOTES:

- HIGHEST OBSERVABLE TIDE LINE DELINEATED BY STEVEN D. RIKER, CWS ON 8/10/2017 IN ACCORDANCE WITH THE FOLLOWING STANDARDS:
 A) U.S. ARMY CORPS OF ENGINEERS WETLANDS DELINEATION MANUAL, TECHNICAL REPORT Y-87-1 (JAN. 1987), AND REGIONAL SUPPLEMENT TO THE CORPS OF ENGINEERS WETLAND DELINEATION MANUAL: NORTHCENTRAL AND NORTHEAST REGION, VERSION 2.0, JANUARY 2012.
 B) FIELD INDICATORS OF HYDRIC SOILS IN THE UNITED STATES, VERSION 8.1, USDA-NRCS, 2017 AND (FOR DISTURBED SITES) FIELD INDICATORS FOR IDENTIFYING HYDRIC SOILS IN NEW ENGLAND, VERSION 4. NEWPCC WETLANDS WORK GROUP (2017).
 C) NATIONAL LIST OF PLANT SPECIES THAT OCCUR IN WETLANDS: NORTHEAST (REGION 1), USFWS (MAY 1988).
 D) CLASSIFICATION OF WETLANDS AND DEEPWATER HABITATS OF THE UNITED STATES, USFW MANUAL FWS/OBS-79/31 (1997).
 E) IDENTIFICATION AND DOCUMENTATION OF VERNAL POOLS IN NEW HAMPSHIRE (1997), NEW HAMPSHIRE FISH AND GAME DEPARTMENT.
- WETLAND FLAGS WERE FIELD LOCATED BY AMBIT ENGINEERING, INC.

PLANTING NOTES

NATIVE SHRUB PLANTING AREA:
SHRUB PLANTINGS:
 NORTHERN ARROWWOOD (VIBURNUM RECOGNITUM) (1 GAL) (25%)
 SILKY DOGWOOD (CORNUS AMOMUM) (1 GAL) (25%)
 WILD RAISIN (VIBURNUM CASSINOIDES) (1 GAL) (25%)
 SPECKLED ALDER (ALNUS RUGOSA) (1 GAL) (25%)
 PLANT EVERY 4 FT ON CENTER IN THE NATIVE SHRUB AREA. SHRUB PLANTINGS ARE TO BE EVENLY DISTRIBUTED BY SPECIES THROUGHOUT.

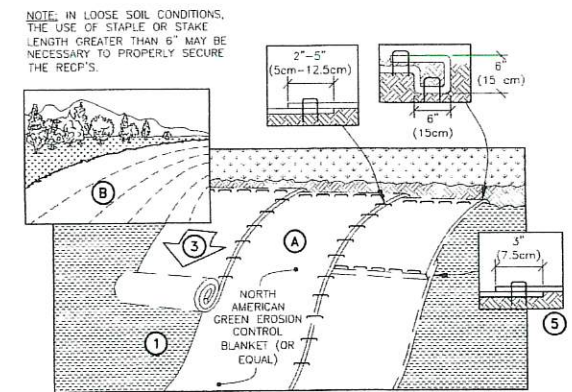

- NOTES:**
- PREPARE SOIL BEFORE INSTALLING ROLLED EROSION CONTROL PRODUCTS (RECP'S), INCLUDING ANY NECESSARY APPLICATION OF LIME, FERTILIZER, AND SEED. NOTE: WHEN USING CELL-0-SEED DO NOT SEED PREPARED AREA CELL-0-SEED MUST BE INSTALLED WITH PAPER SIDE DOWN.
 - BEGIN AT THE TOP OF THE SLOPE BY ANCHORING THE RECP'S IN A 6" DEEP & 5" WIDE TRENCH WITH APPROXIMATELY 12" OF RECP'S EXTENDED BEYOND THE UP-SLOPE PORTION OF THE TRENCH. ANCHOR THE RECP'S WITH A ROW OF STAPLES/STAKES APPROXIMATELY 12" APART IN THE BOTTOM OF THE TRENCH. BACKFILL AND COMPACT THE TRENCH AFTER STAPLING. APPLY SEED TO COMPACTED SOIL AND FOLD REMAINING 12" PORTION OF RECP'S BACK OVER SEED AND COMPACTED SOIL. SECURE RECP'S OVER COMPACTED SOIL WITH A ROW OF STAPLES/STAKES SPACED APPROXIMATELY 12" APART ACROSS THE WIDTH OF THE RECP'S.
 - ROLL THE RECP'S (A.) DOWN OR (B.) HORIZONTALLY ACROSS THE SLOPE. RECP'S WILL UNROLL WITH APPROPRIATE SIDE AGAINST THE SOIL SURFACE. ALL RECP'S MUST BE SECURELY FASTENED TO SOIL SURFACE BY PLACING STAPLES/STAKES IN APPROPRIATE LOCATIONS AS SHOWN IN THE STAPLE PATTERN GUIDE. WHEN USING THE DOT SYSTEM, STAPLES/STAKES SHOULD BE PLACED THROUGH EACH OF THE COLORED DOTS CORRESPONDING TO THE APPROPRIATE STAPLE PATTERN.
 - THE EDGES OF PARALLEL RECP'S MUST BE STAPLED WITH APPROXIMATELY 2"-5" OVERLAP DEPENDING ON RECP'S TYPE.
 - CONSECUTIVE RECP'S SPICED DOWN THE SLOPE MUST BE PLACED END OVER END (SHINGLE STYLE) WITH AN APPROXIMATE 3" OVERLAP. STAPLE THROUGH OVERLAPPED AREA, APPROXIMATELY 12" APART ACROSS ENTIRE RECP'S WIDTH.

1 EROSION CONTROL BLANKET
C2 NORTH AMERICAN GREEN SLOPE TREATMENT NTS

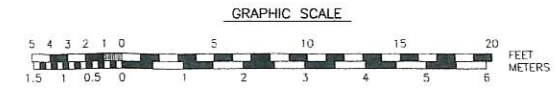
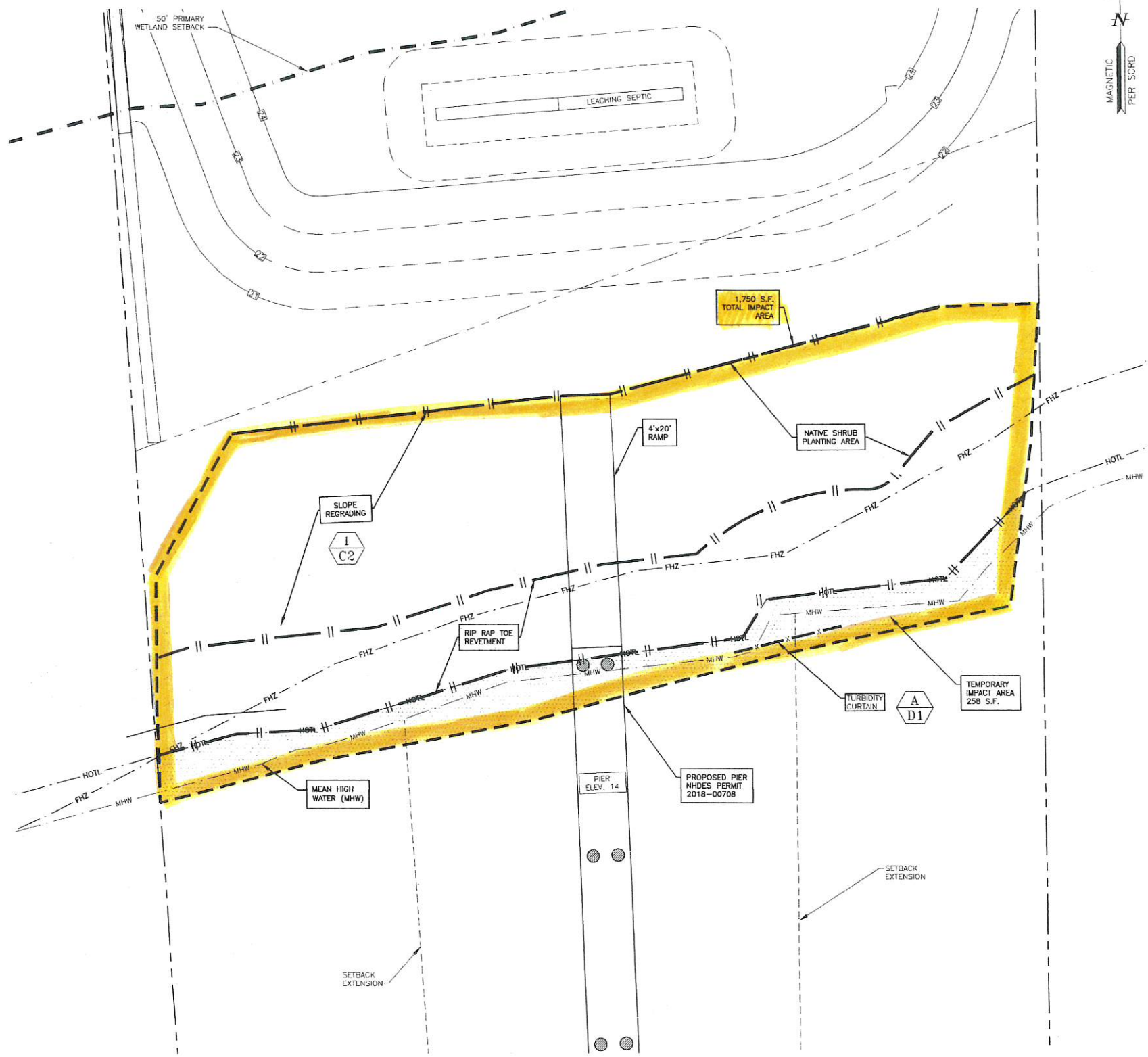

NOTES:

- PARCEL IS SHOWN ON THE TOWN OF DURHAM ASSESSOR'S MAP 12 AS LOT 1-8.
- OWNERS OF RECORD:
 MANISHA P. HEIDERSCHIEDT
 2010 REVOCABLE TRUST
 MANISHA P. HEIDERSCHIEDT &
 BENEDICT G. HEIDERSCHIEDT, TRUSTEES
 21 CAVERNO DRIVE
 LEE, NH 03861
 4495/149
- A PORTION OF THE PARCEL IS IN A SPECIAL FLOOD HAZARD AREA AS SHOWN ON FIRM PANEL 33017C0340E. EFFECTIVE DATE SEPTEMBER 30, 2015.
- EXISTING LOT AREA:
 11,794± SF
 0.2708± ACRES
- PARCEL IS LOCATED IN RESIDENCE COASTAL (RC) ZONING DISTRICT AND IS SUBJECT TO THE SHORELAND PROTECTION OVERLAY DISTRICT.
- THE PURPOSE OF THIS PLAN IS TO SHOW THE LOCATION OF PROPOSED RETAINING WALL AND GRADING AS WELL AS REPAIR TO AN EXISTING RETEMENT ON TAX MAP 12 LOT 1-8.
- VERTICAL DATUM IS MEAN LOW LOW WATER LEVEL NAVD88. BASIS OF VERTICAL DATUM IS NH DOT BENCHMARK 133-0410.
- PROPERTY HAS 77' OF SHORE FRONTAGE.

HEIDERSCHIEDT RESIDENCE
32 CEDAR POINT ROAD
DURHAM, N.H.

NO.	DESCRIPTION	DATE
7	REMOVED GRASS PLANTING AREA	9/6/19
6	REMOVED RETAINING WALL	8/23/19
5	PLANTING LIMIT CLARITY	8/9/19
3	ADDED MHW LINE	5/22/19
2	REVISED PATIO LOCATION	2/13/19
1	REVISED PER ACF REVIEW	1/23/19

REVISIONS

SCALE 1"=5' JANUARY 2019

RETEMENT PERMIT PLAN **C2**

J:\JOB22\UN2006\JH 2550\JH 2552\2552.16 Heiderscheidt 32 Cedar Point Road, Durham, NH\2017 Permitting\Plans & Specs\JH 2552.16 Revitment 2019.dwg, c2 permit