



TOWN OF DURHAM
Planning Department
 8 Newmarket Road
 Durham, NH 03824-2898
 Phone (603) 868-8064
 www.ci.durham.nh.us

RECEIVED
 Town of Durham

JAN 28 2022

Planning, Assessing
 and Zoning

Scenic Roads - Application to Remove and/or Trim Trees

Proposed Activity

Mark only those roads where removal or trimming of trees is proposed:

- Bay Road. Approximate number of trees to be removed: 50
- Bennett Road. Approximate number of trees to be removed: 26
- Durham Point Road. Approximate number of trees to be removed: 46
- Packers Falls Road. Approximate number of trees to be removed: 35

Will branches be trimmed also? Yes No

Reason for removal or trimming of trees/additional information: _____

UTILITY MAINTENANCE

Date when work is expected to begin: 3RD QUARTER OF 2022

Applicant

Name of Utility or Other Organization: EVERSOURCE

Representative: ROBERT BERGER; Title: ARBORIST

Telephone #: 603-345-0636 Email: ROBERT.BERGER@EVERSOURCE.COM

Contractor

Name (include name of individual): ASPLUNDH - TREE EXPERT - TERRY COOPER

Telephone #: 207-432-0593 Email: TCCOOPER2@ASPLUNDH.COM

Submission of Application

I hereby submit this application to the Town of Durham Planning Board and attest to the best of my knowledge that the information on this application and in the accompanying documentation is true and accurate. I will carefully review the General Policy For Utility Maintenance Tree Trimming and Tree Removal on Scenic Roads In Durham, NH, adopted by the Durham Planning Board on October 24, 2018.

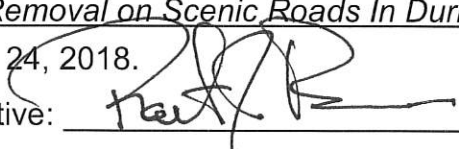
Signature of duly authorized representative: 

Date: 1.24.22

RECEIVED
Town of Durham

JAN 28 2022

Planning Board
Town of Durham
8 Newmarket Road
Durham, NH 03824

Planning, Assessing
and Zoning

January 20, 2022

Dear Planning Board Members:

This letter is to inform the Town of Durham that Eversource is planning to trim and remove trees and brush adjacent to and beneath some of its power lines within the town. This work is necessary to ensure the safe distribution of power and to improve the reliability of electric service for our customers

According to Eversource records Bennett Road, Packers Falls Road, Durham Point Road, and Bay Road have been designated as scenic roads by the Town. Please consider this letter a request from Eversource for a public hearing for the trimming and removal of trees and brush along these roads within the proposed work area pursuant to RSA 231:158. Please inform this office of the time and place of said meeting so that we may have a representative present. A map highlighting the areas to be trimmed is enclosed.

Eversource specifications call for the removal of brush and limbs which are located within eight feet to the side, ten feet below or fifteen above conductors. Trees which present a threat to Eversource lines or other equipment because of decay, or another defect will be removed on a case-by-case basis. A list of "risk" trees identified for removal by Eversource has been included. All trees are marked with a blue and white checkered ribbon.

All work will be performed in accordance with accepted arboricultural standards. Eversource has contracted with Asplundh Tree Expert to perform the actual clearing of trees. Eversource requires that our clearing contractor contact each landowner where trees are to be trimmed or removed prior to commencement of work on that property. Individual concerns will be addressed at this time.

All brush and limbs cut on roadside locations will be chipped. In wooded, undeveloped locations, these chips may be dispersed into the woods taking care not to allow chips to accumulate in piles or in ditches. Near developed land, the chips will be blown into a truck and disposed of offsite. The chips make good mulch and are often given to nearby property owners for landscaping purposes. If a central dumping location could be arranged, Eversource would be happy to make any unclaimed chips available to the Town at no cost. Brush and limbs cut on inaccessible lines will be stacked to the side of the right-of way and cut low to the ground. All wood will be left on site unless otherwise directed by the landowner.

Work is scheduled to begin in the near future.

If you have any questions or comments, please feel free to contact me at the above address, by telephone at 603-634-3469 or by e-mail at Robert.Berner@Eversource.com.

Thank you for your concern and assistance.

Respectfully,



Robert J. Berner
Eastern Region Arborist
Eversource

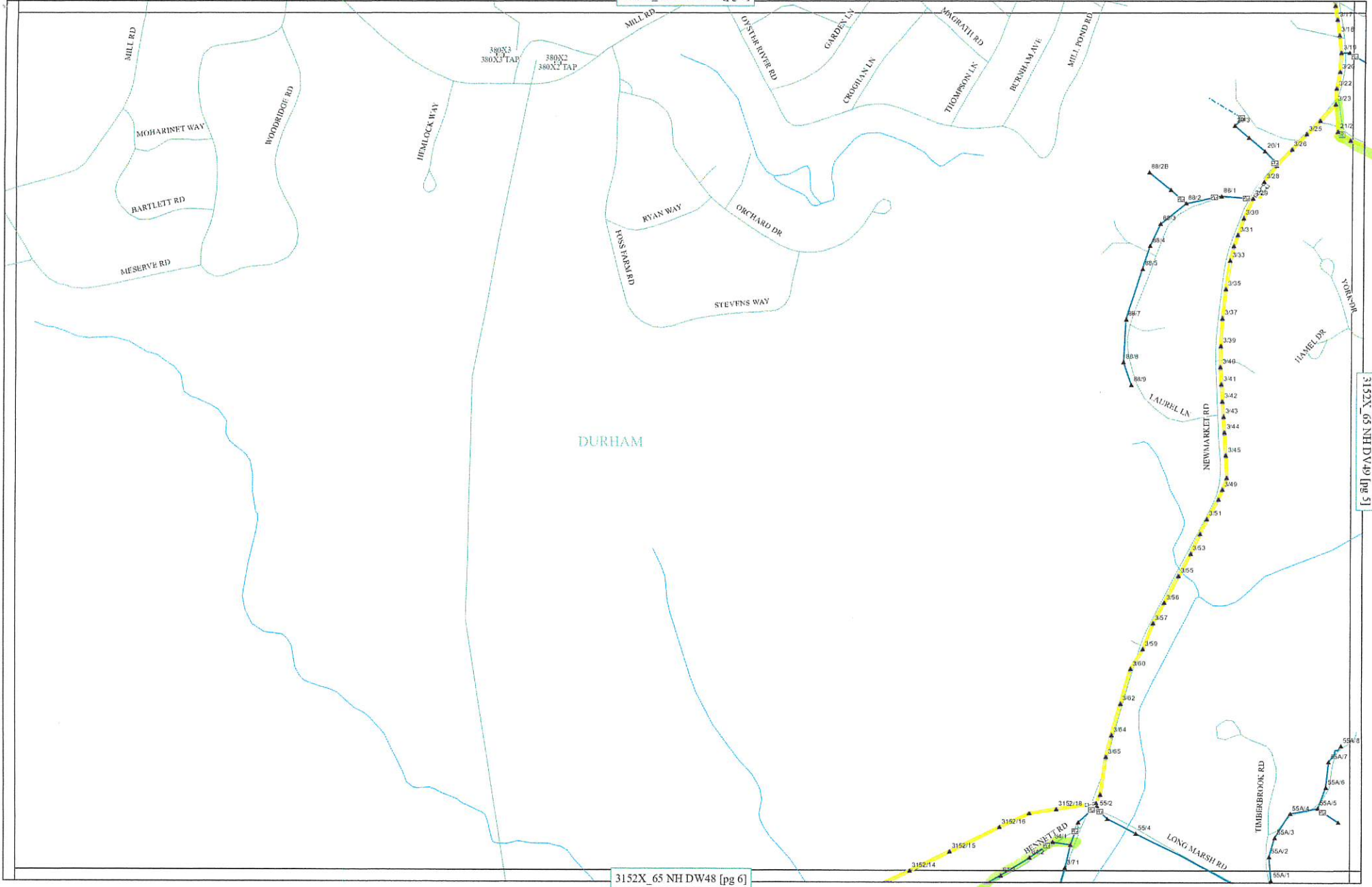

EVERSOURCE ENERGY GIS

PROPRIETARY INFORMATION: The material contained on the Overhead Distribution Circuit Map shall be considered proprietary to Eversource Energy, and Users (which shall be defined as any person or entity who has received the Map through sale, purchase, exchange gift, or otherwise) shall keep it in confidence and shall not furnish or disclose it to any third party without the prior written permission of Eversource Energy.

- Cutout
- ▲ Pole
- Recloser
- Switch Bank
- Open Point
- ▲ Stepdown Bank
- ▲ Tiepoint
- OH Primary
- OH Backbone
- OH Lateral
- UG Primary
- UG Backbone
- UG Lateral
- Hydrology
- Streets
- Substation
- Town Boundaries



Circuit Mileage

Backbone	5.23
Lateral	13.50
Total	18.73



Page:
4 of 7

3152X_65 NH DV48

Circuit: 3152X_65
District: Eastern
AWC: Epping

Plotted:
6/15/2020



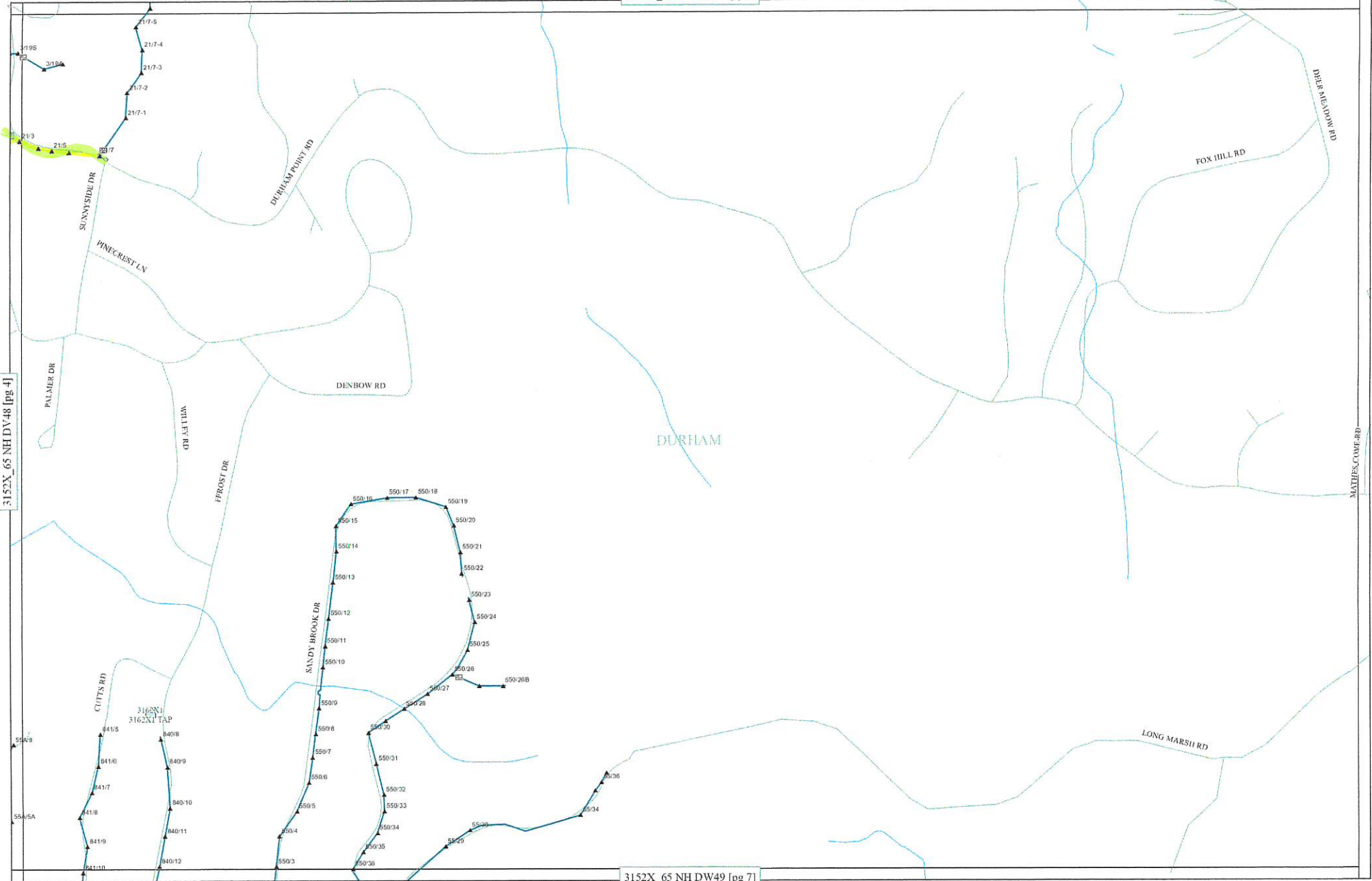

3152X_65 NH DV48 [pg 4]

3152X_65 NH DW49 [pg 7]

EVERSOURCE ENERGY GIS

PROPRIETARY INFORMATION: The material contained on the Overhead Distribution Circuit Map shall be considered proprietary to Eversource Energy, and Users (which shall be defined as any person or entity who has received the Map through sale, purchase, exchange gift, or otherwise) shall keep it in confidence and shall not furnish or disclose it to any third party without the prior written permission of Eversource Energy.

- | | | | | |
|---------------|-----------------|-------------------|-------------------|-------------------|
| □ Cutout | ○ Open Point | OH Primary | UG Primary | — Hydrology |
| ▲ Pole | ▲ Stepdown Bank | — OH Backbone | — UG Backbone | — Streets |
| ▲ Recloser | ▲ Tiepoint | — OH Lateral | — UG Lateral | □ Substation |
| □ Switch Bank | | | | □ Town Boundaries |



Circuit Mileage

Backbone	5.23
Lateral	13.50
Total	18.73



Page:

5 of 7

3152X_65 NH DV49

Circuit: 3152X_65
District: Eastern
AWC: Epping

Plotted:
6/15/2020



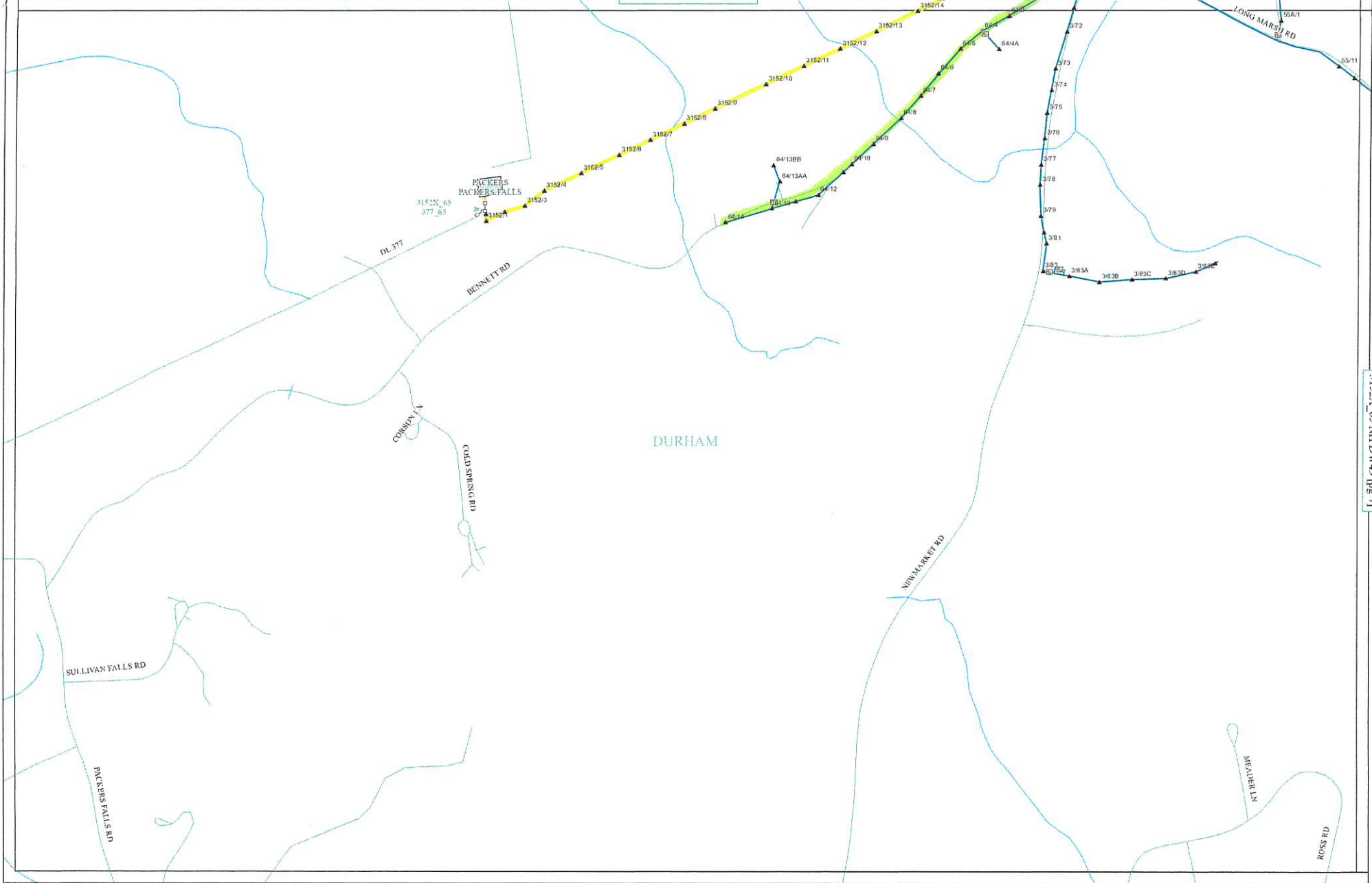

EVERSOURCE ENERGY GIS

PROPRIETARY INFORMATION: The material contained on the Overhead Distribution Circuit Map shall be considered proprietary to Eversource Energy, and Users (which shall be defined as any person or entity who has received the Map through sale, purchase, exchange gift, or otherwise) shall keep it in confidence and shall not furnish or disclose it to any third party without the prior written permission of Eversource Energy.

<ul style="list-style-type: none"> ☐ Cutout ▲ Pole ☒ Recloser ◻ Switch Bank 	<ul style="list-style-type: none"> ○ Open Point ▲ Stepdown Bank ▲ Tiepoint 	<ul style="list-style-type: none"> OH Primary — OH Backbone — OH Lateral 	<ul style="list-style-type: none"> UG Primary --- UG Backbone --- UG Lateral 	<ul style="list-style-type: none"> — Hydrology — Streets ▭ Substation ▭ Town Boundaries
---	---	--	--	---



Circuit Mileage

Backbone	5.23
Lateral	13.50
Total	18.73



Page:

6 of 7

3152X_65 NH DW48

Circuit: 3152X_65
District: Eastern
AWC: Epping

Plotted:
6/15/2020



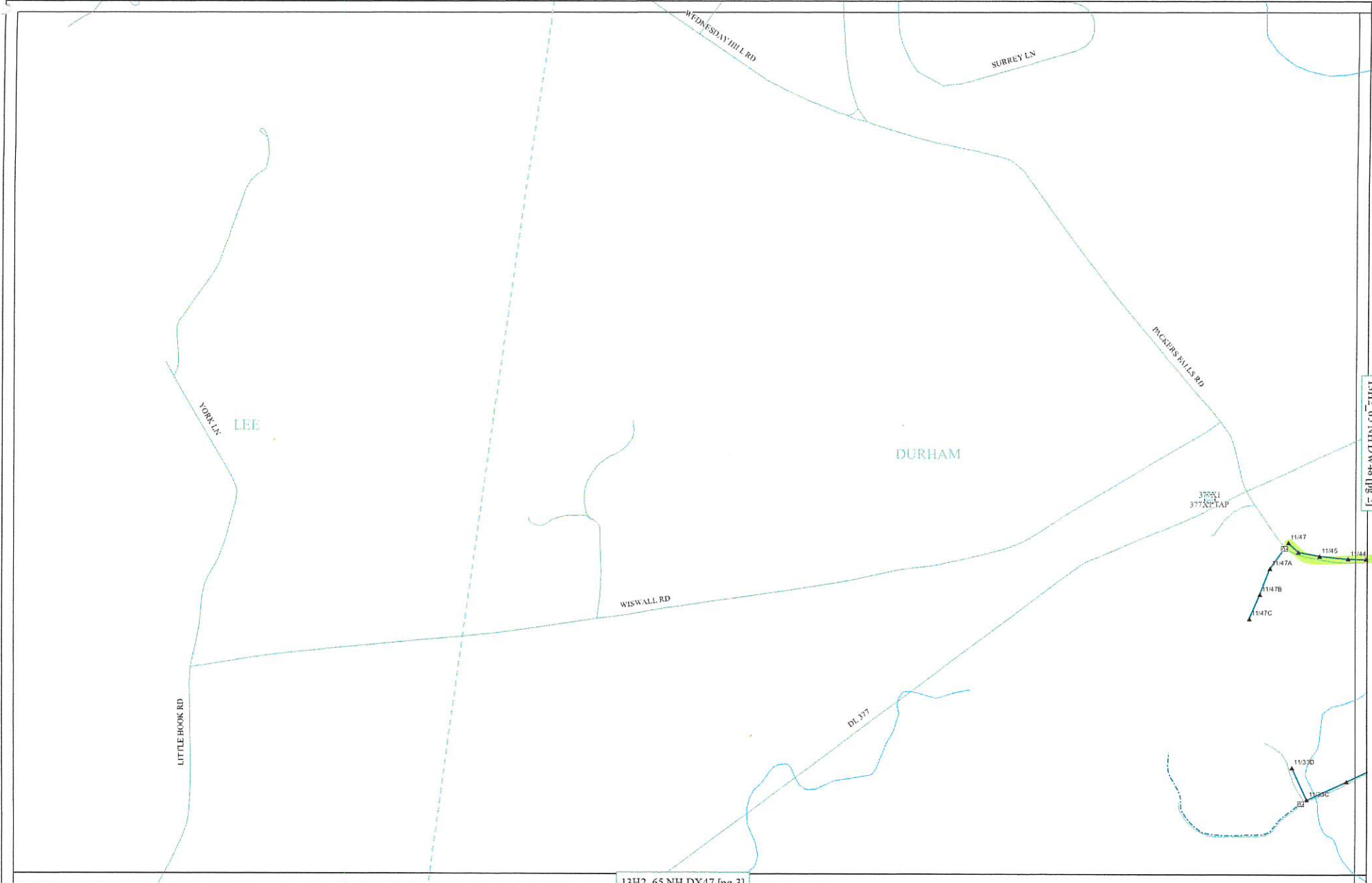

13H2_65 NH DX47 [pg 3]

13H2_65 NH DW48 [pg 2]

EVERSOURCE ENERGY GIS

PROPRIETARY INFORMATION: The material contained on the Overhead Distribution Circuit Map shall be considered proprietary to Eversource Energy, and Users (which shall be defined as any person or entity who has received the Map through sale, purchase, exchange gift, or otherwise) shall keep it in confidence and shall not furnish or disclose it to any third party without the prior written permission of Eversource Energy.

0 400 800 1,200 Feet

1 inch = 400 feet

□ Cutout	Open Point	OH Primary	UG Primary	— Hydrology
▲ Pole	▲ Stepdown Bank	— OH Backbone	— UG Backbone	— Streets
□ Recloser	▼ Tiepoint	— OH Lateral	— UG Lateral	□ Substation
□ Switch Bank				□ Town Boundaries

Circuit Mileage

Backbone	0.81
Lateral	5.63
Total	6.44



Page:

1 of 5

13H2_65 NH DW47

Circuit: 13H2_65
District: Eastern
AWC: Epping

Plotted:
6/15/2020



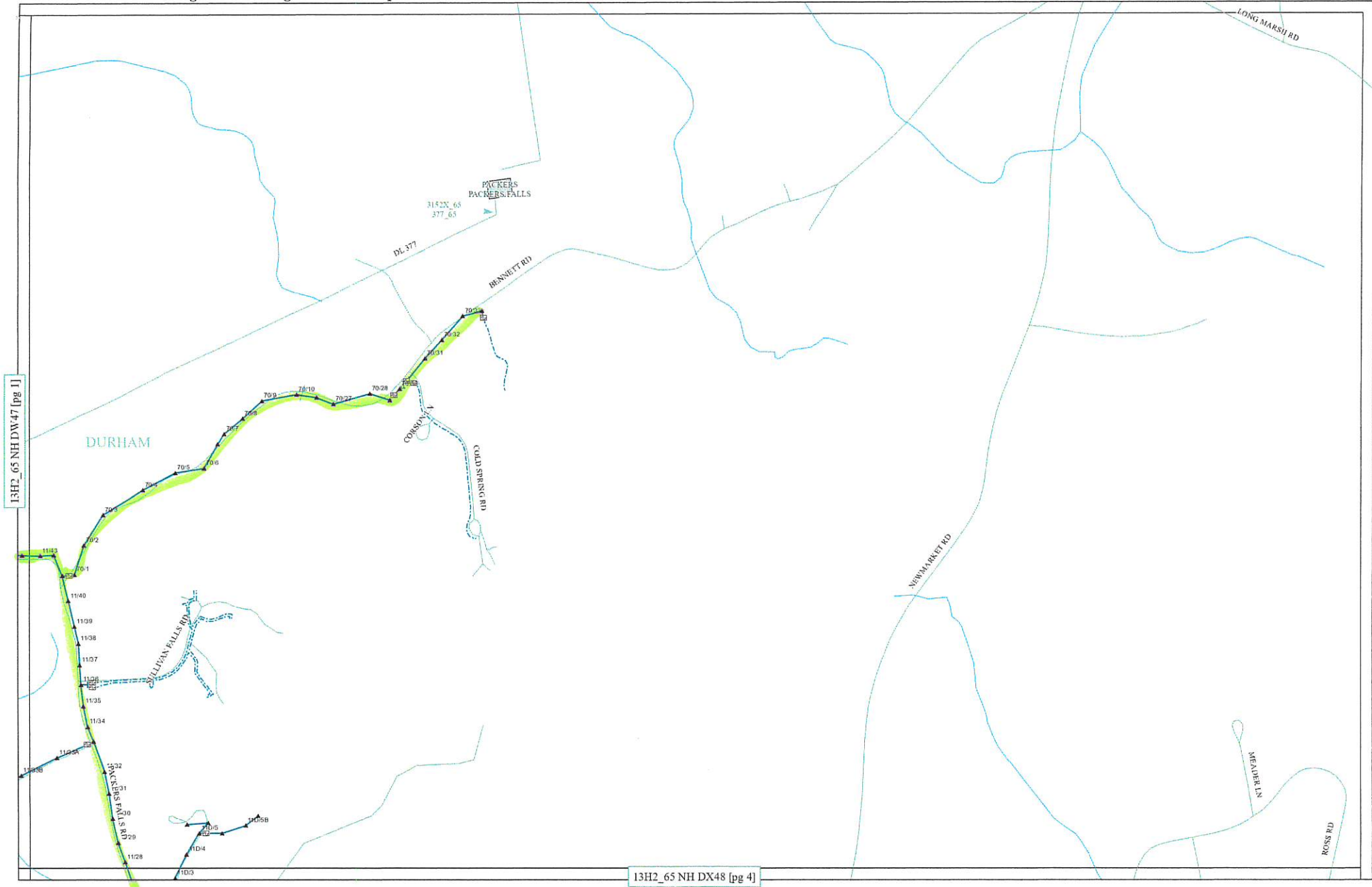

13H2_65 NH DW47 [pg 1]

13H2_65 NH DX48 [pg 4]

EVERSOURCE ENERGY GIS

PROPRIETARY INFORMATION: The material contained on the Overhead Distribution Circuit Map shall be considered proprietary to Eversource Energy, and Users (which shall be defined as any person or entity who has received the Map through sale, purchase, exchange gift, or otherwise) shall keep it in confidence and shall not furnish or disclose it to any third party without the prior written permission of Eversource Energy.

- Cutout
- ▲ Pole
- Recloser
- Switch Bank
- Open Point
- ▲ Stepdown Bank
- ▲ Tiepoint
- OH Primary**
- OH Backbone
- OH Lateral
- UG Primary**
- UG Backbone
- UG Lateral
- Hydrology
- Streets
- Substation
- Town Boundaries



Circuit Mileage

Backbone	0.81
Lateral	5.63
Total	6.44



Page:
2 of 5

13H2_65 NH DW48

Circuit: 13H2_65
District: Eastern
AWC: Epping

Plotted:
6/15/2020





13H2_65 NH DX47 [pg 3]

13H2_65 NH DY48 [pg 5]

EVERSOURCE ENERGY GIS

PROPRIETARY INFORMATION: The material contained on the Overhead Distribution Circuit Map shall be considered proprietary to Eversource Energy, and Users (which shall be defined as any person or entity who has received the Map through sale, purchase, exchange gift, or otherwise) shall keep it in confidence and shall not furnish or disclose it to any third party without the prior written permission of Eversource Energy.

- Cutout
- ▲ Pole
- ◻ Recloser
- Switch Bank
- Open Point
- ▲ Stepdown Bank
- ▲ Tiepoint
- OH Primary
- OH Backbone
- OH Lateral
- UG Primary
- UG Backbone
- UG Lateral
- Hydrology
- Streets
- Substation
- Town Boundaries

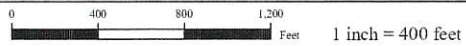

Circuit Mileage

Backbone	0.81
Lateral	5.63
Total	6.44

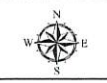

Page:
4 of 5

13H2_65 NH DX48

Circuit: 13H2_65
District: Eastern
AWC: Epping

Plotted:
6/15/2020



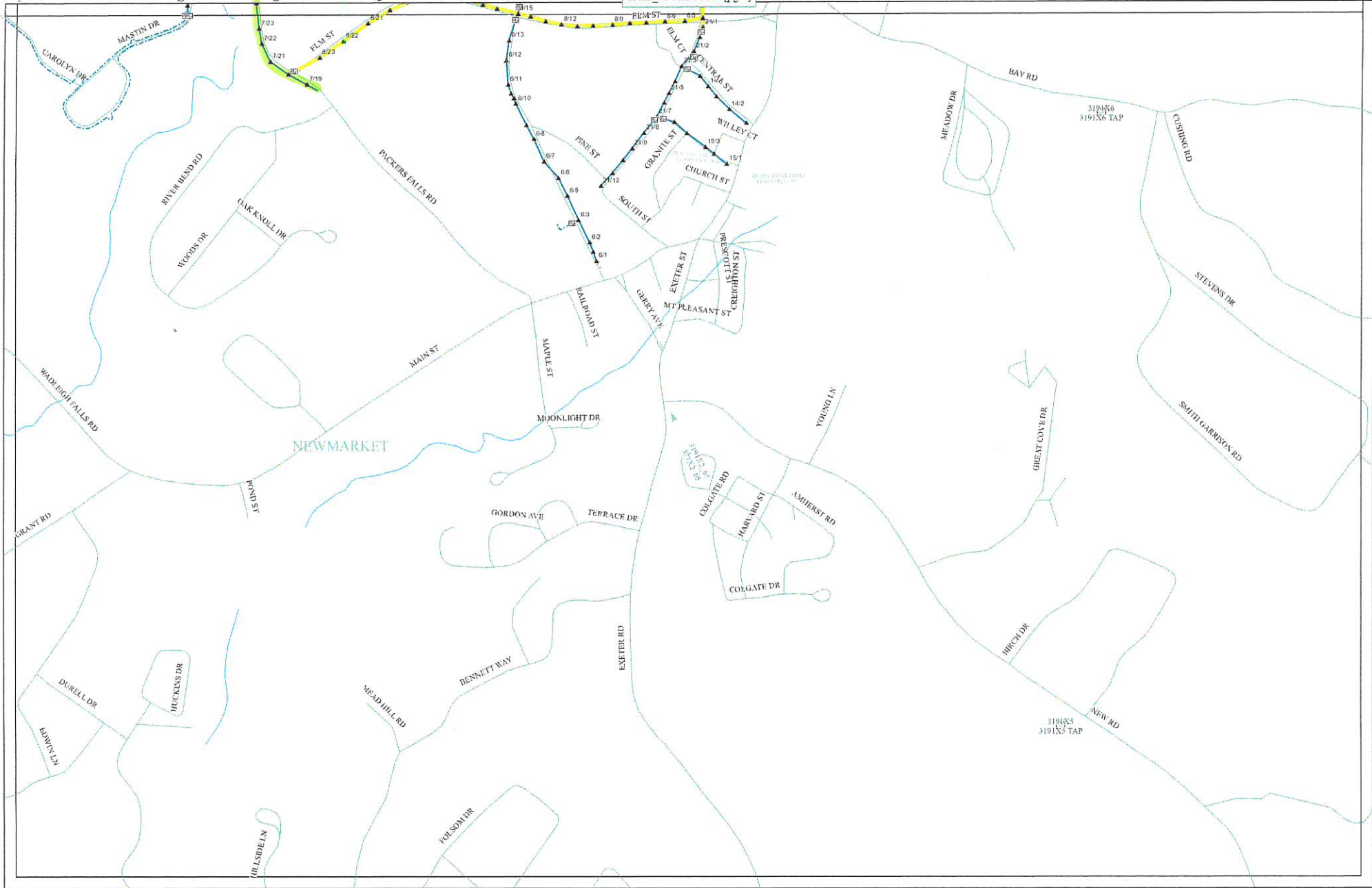

EVERSOURCE ENERGY GIS

PROPRIETARY INFORMATION: The material contained on the Overhead Distribution Circuit Map shall be considered proprietary to Eversource Energy, and Users (which shall be defined as any person or entity who has received the Map through sale, purchase, exchange gift, or otherwise) shall keep it in confidence and shall not finish or disclose it to any third party without the prior written permission of Eversource Energy.

- | | | | | |
|---------------|-----------------|-------------------|-------------------|-------------------|
| □ Cutout | ○ Open Point | OH Primary | UG Primary | — Hydrology |
| ▲ Pole | ▲ Stepdown Bank | — OH Backbone | — UG Backbone | — Streets |
| □ Recloser | ▲ Tiepoint | — OH Lateral | — UG Lateral | □ Substation |
| ○ Switch Bank | | | | □ Town Boundaries |



Circuit Mileage

Backbone	0.81
Lateral	5.63
Total	6.44



Page:

5 of 5

13H2_65 NH DY48

Circuit: 13H2_65
District: Eastern
AWC: Epping

Plotted:
6/15/2020



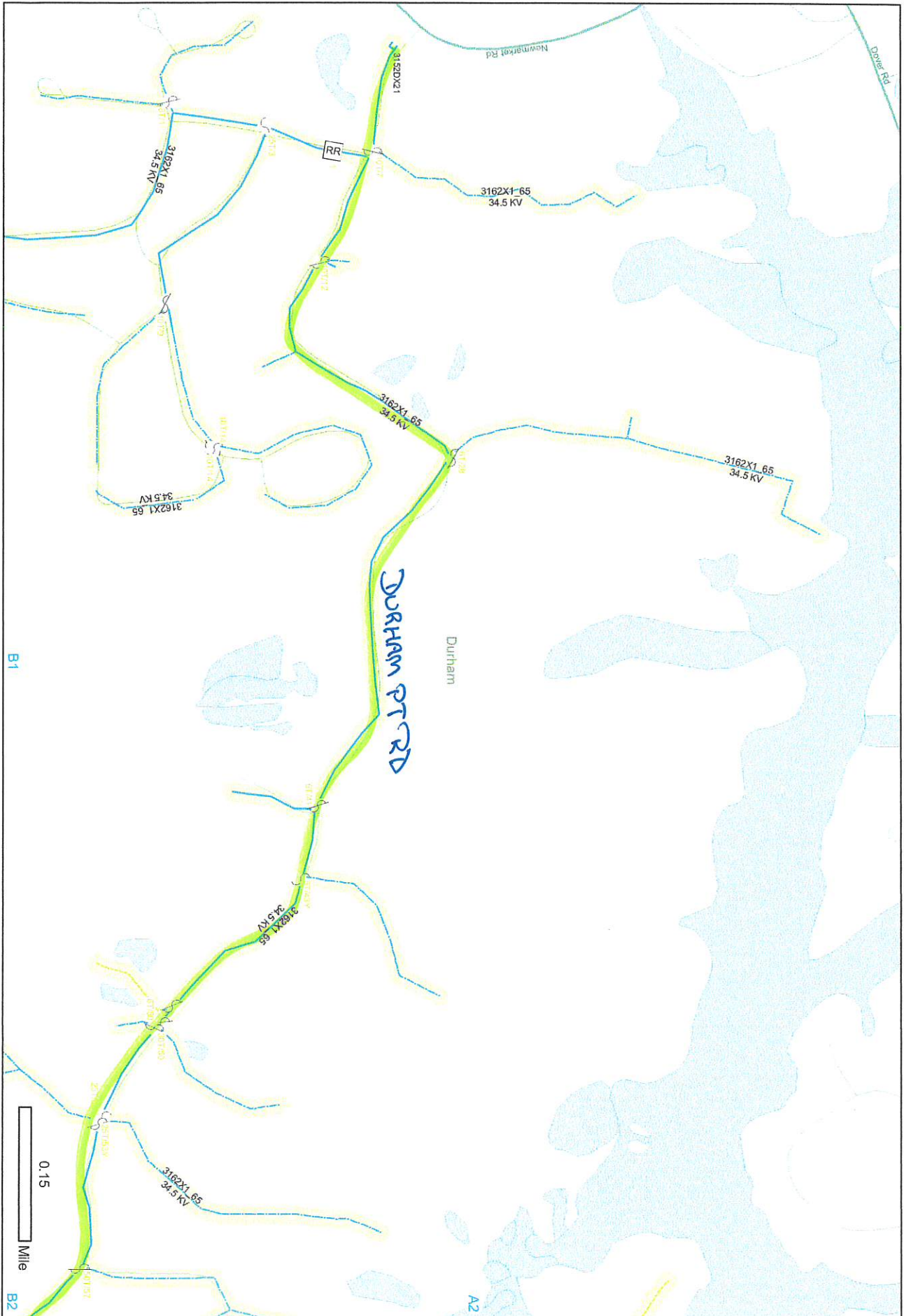

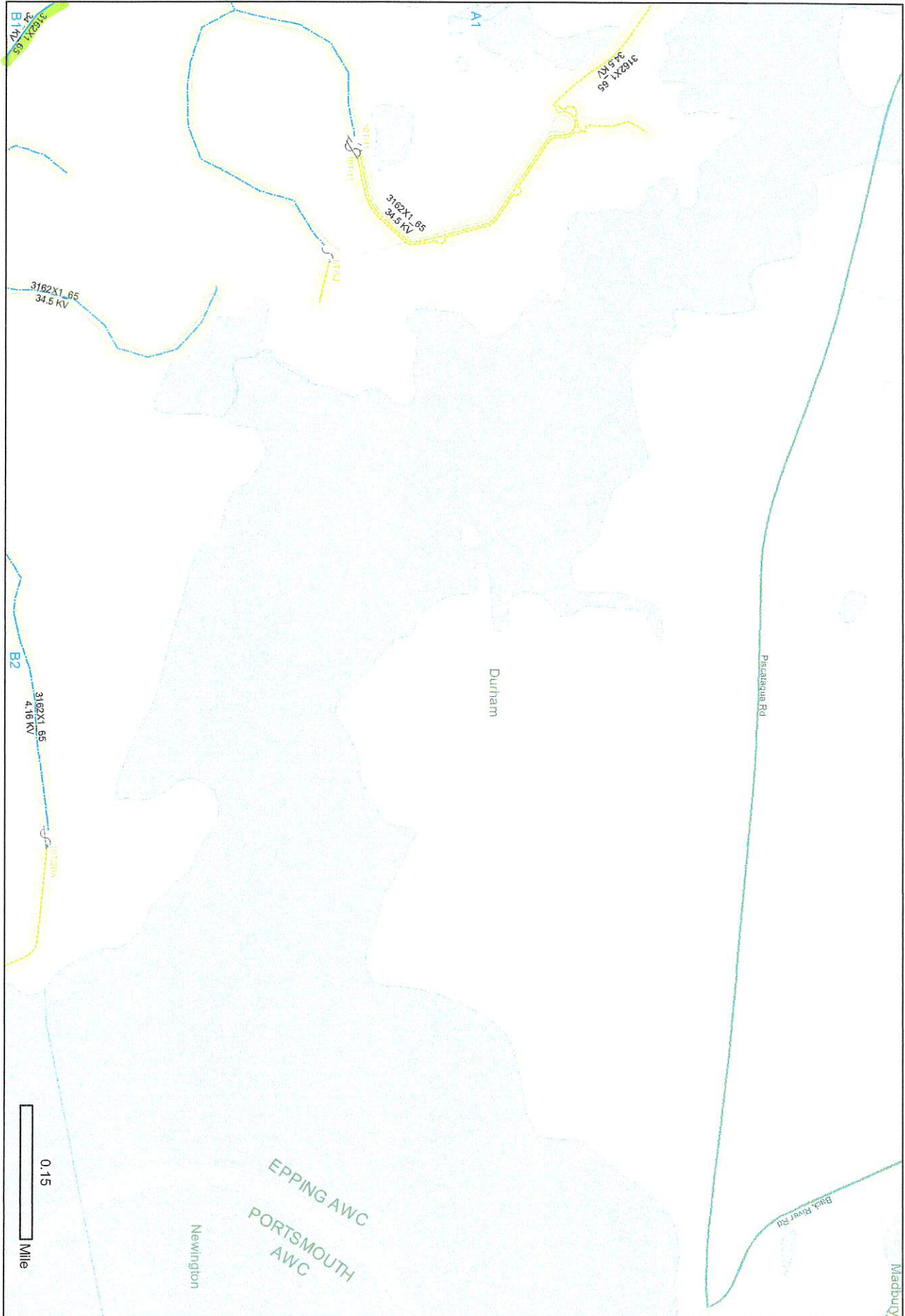

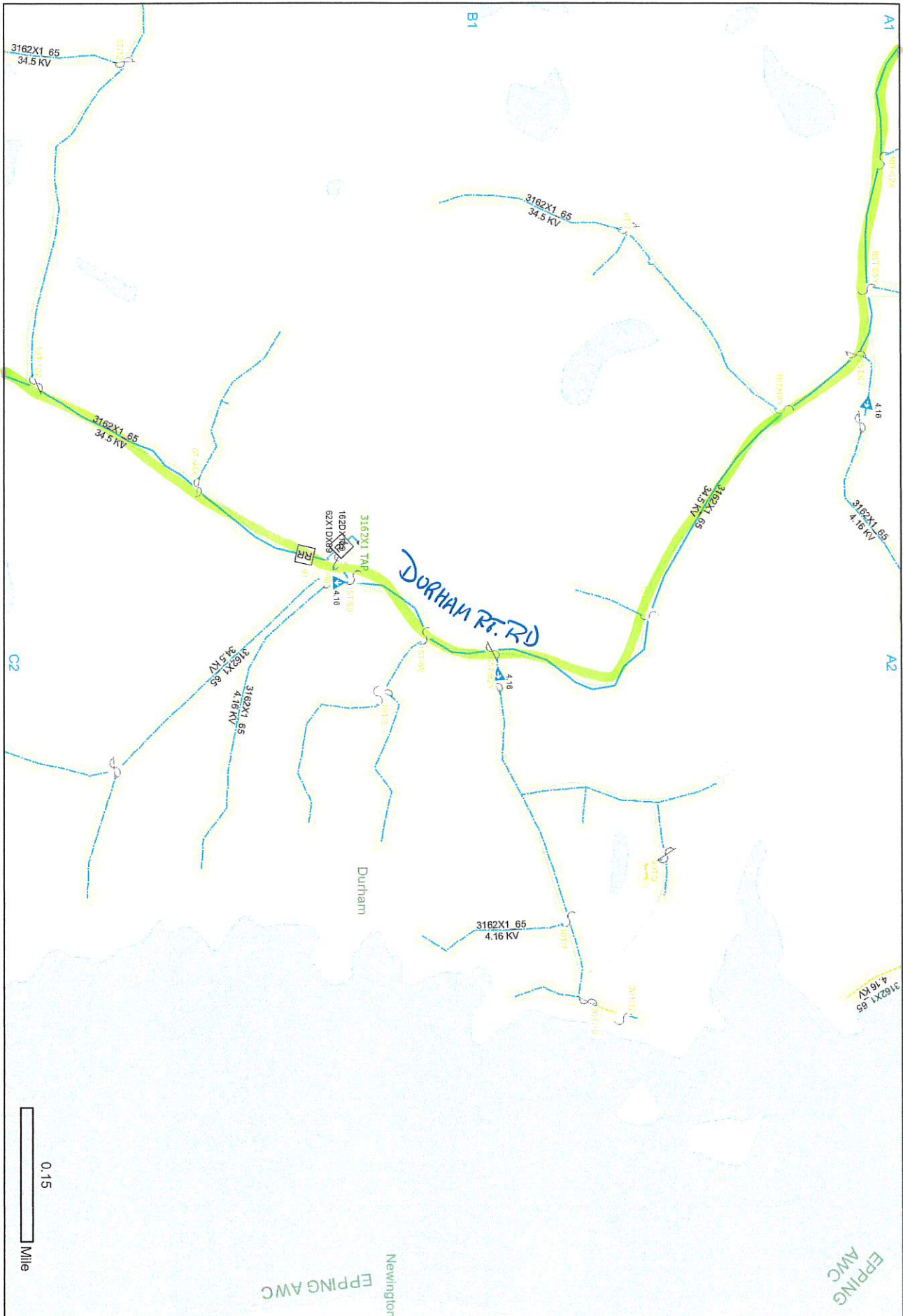

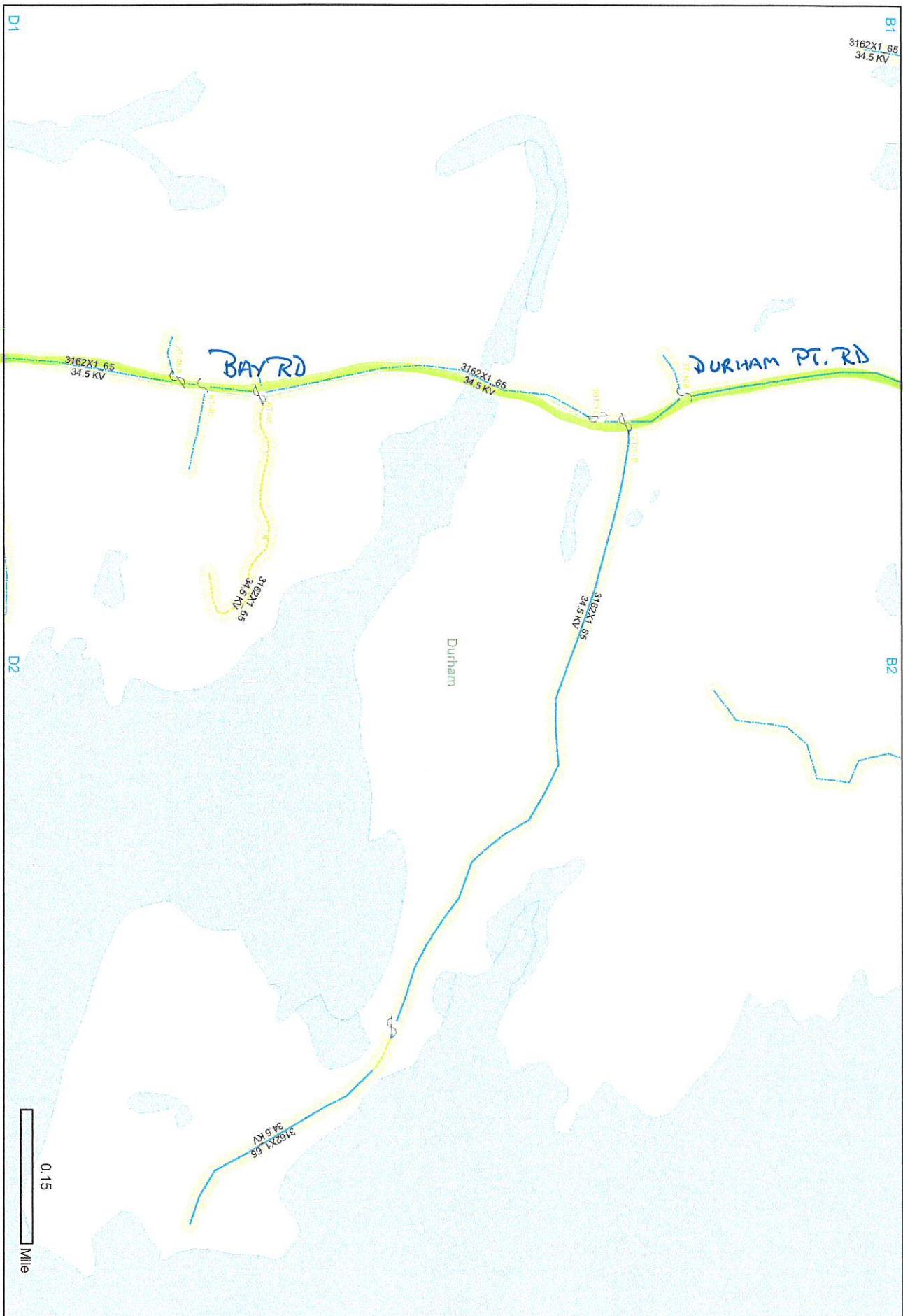

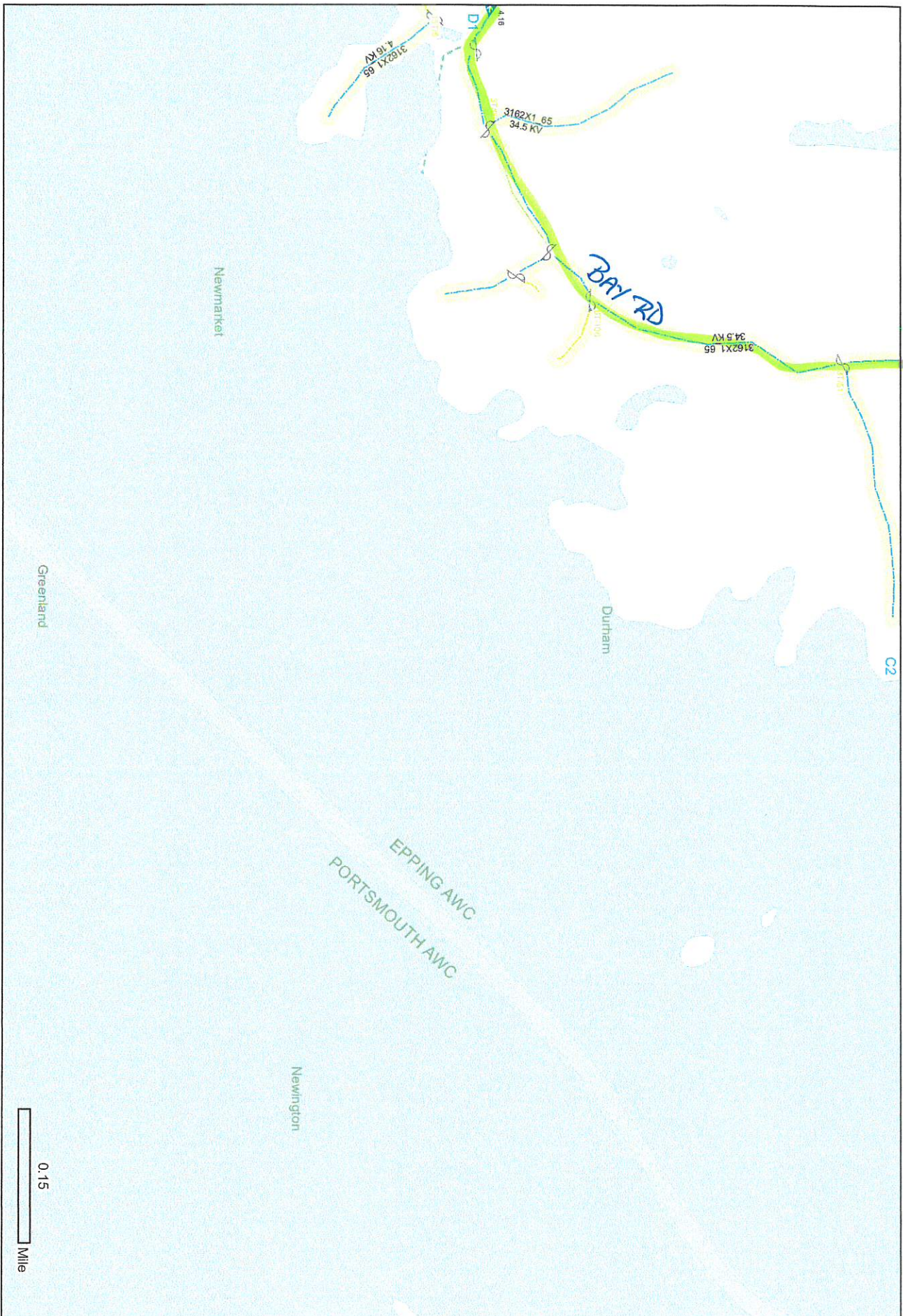

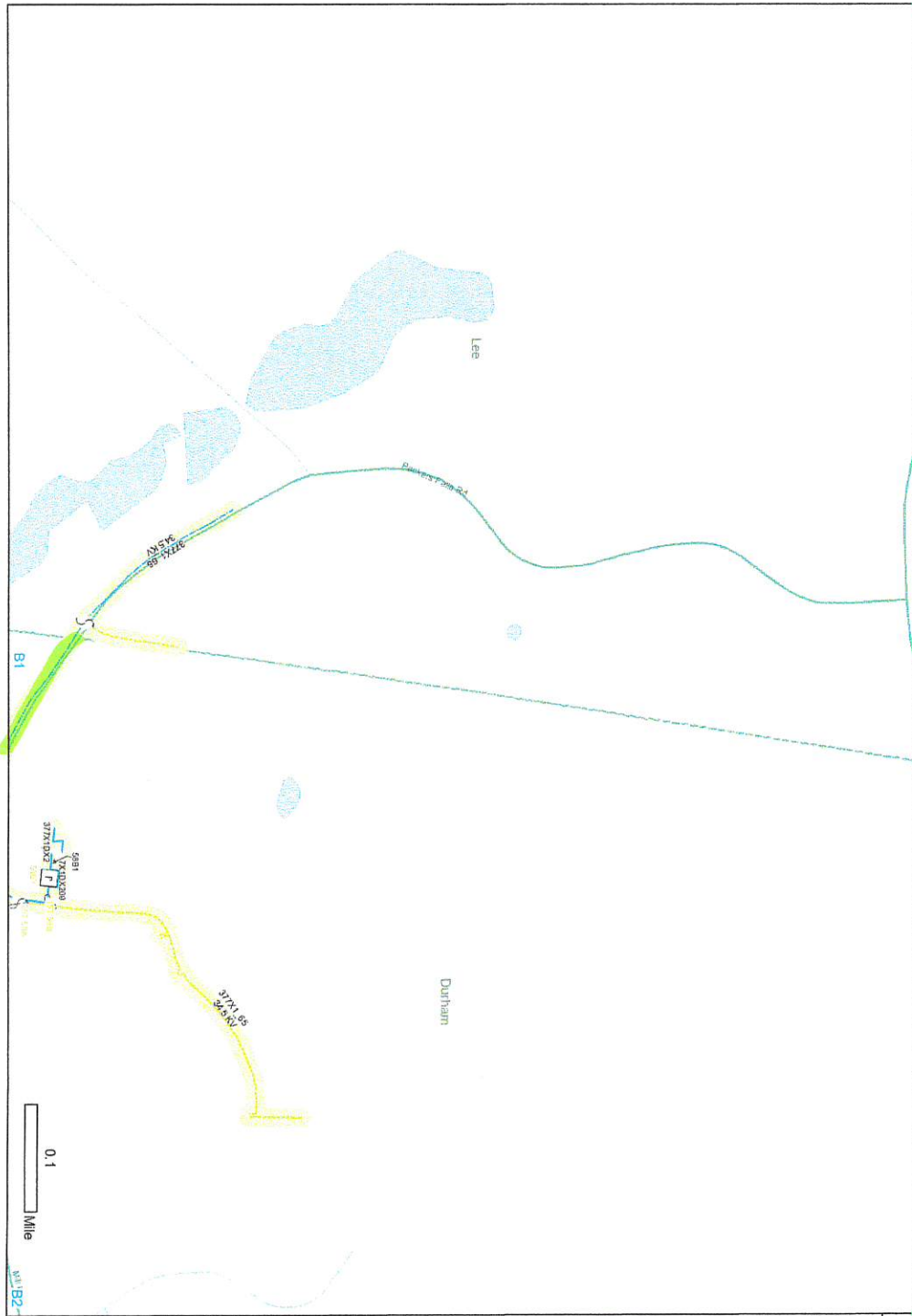

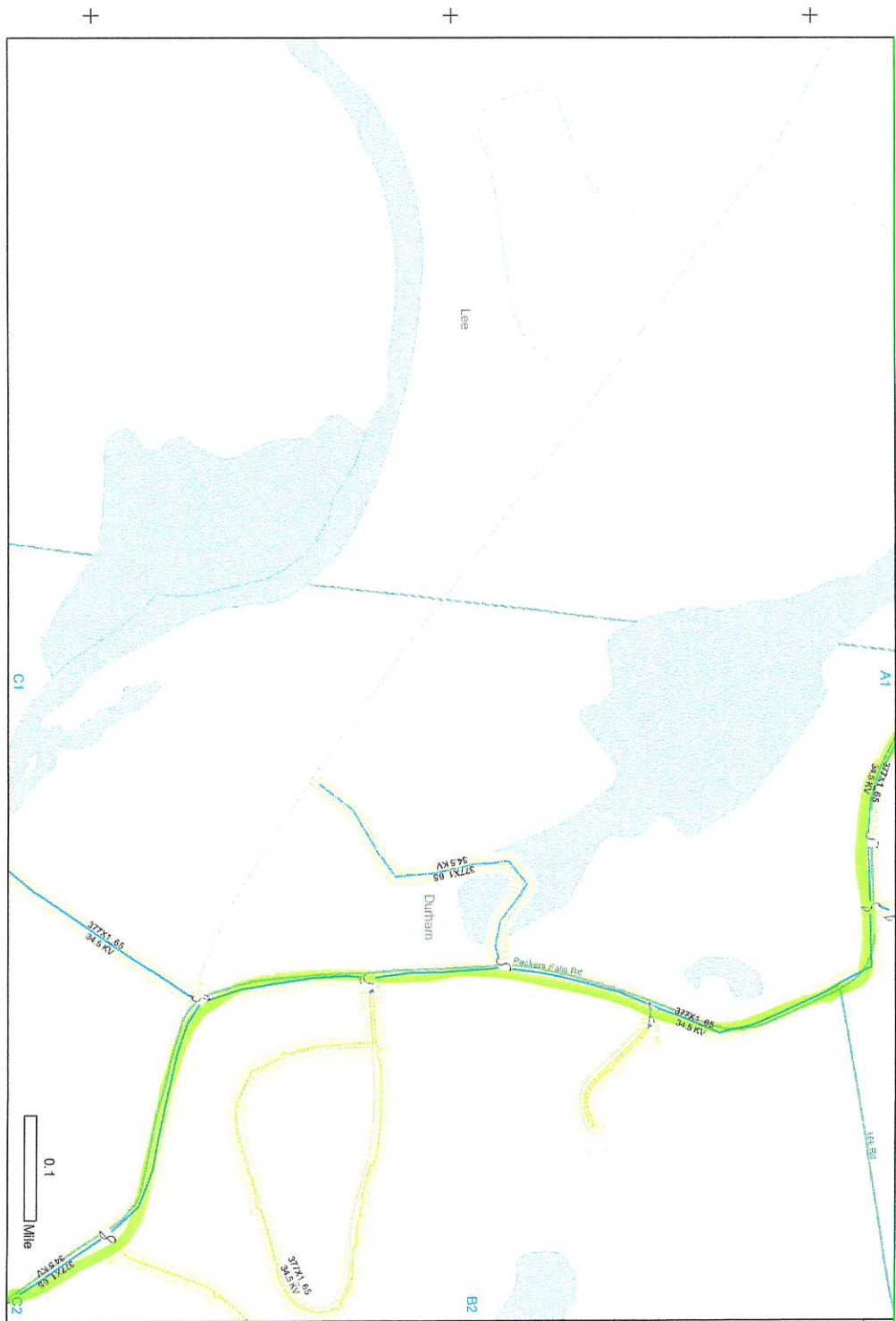

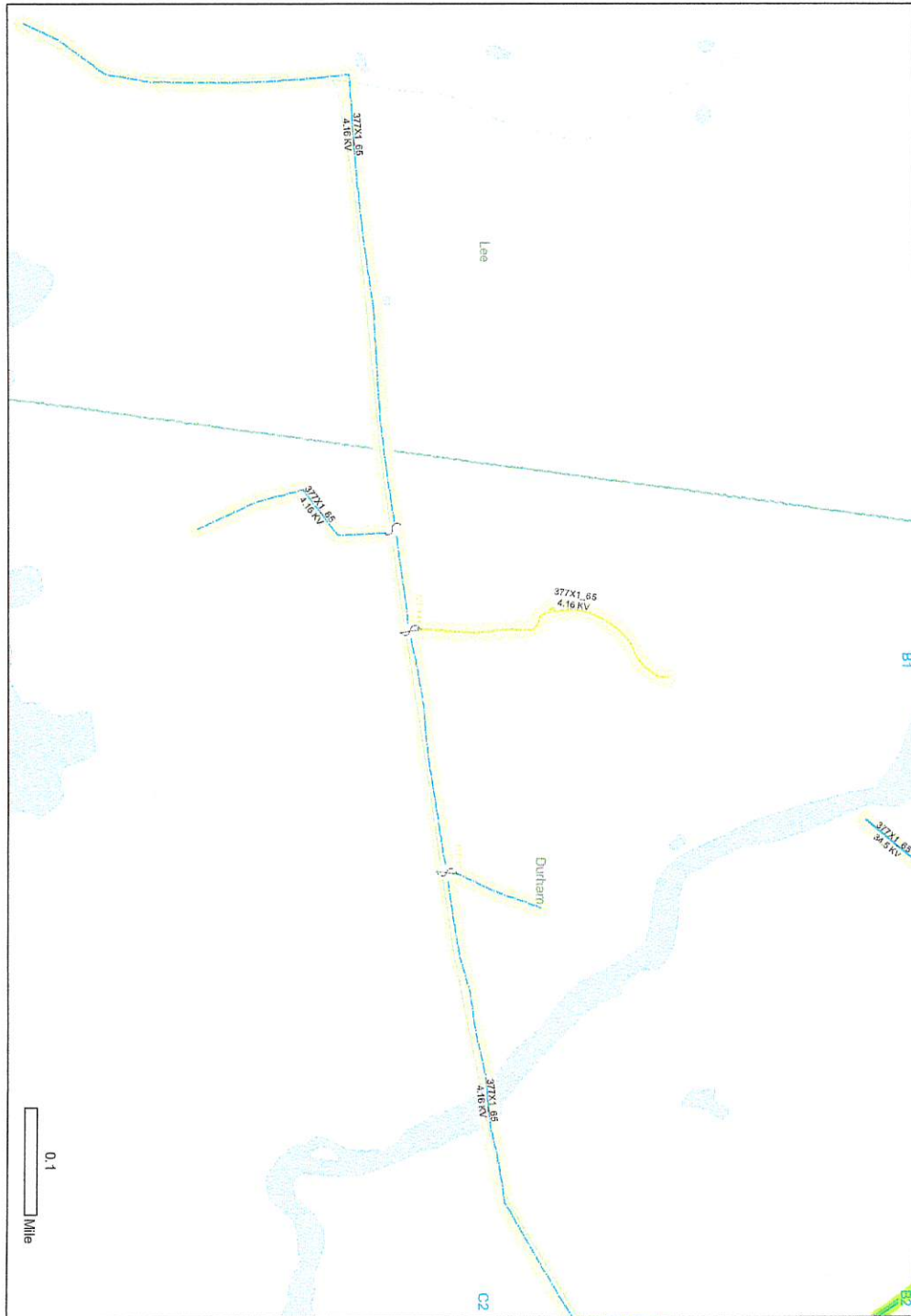

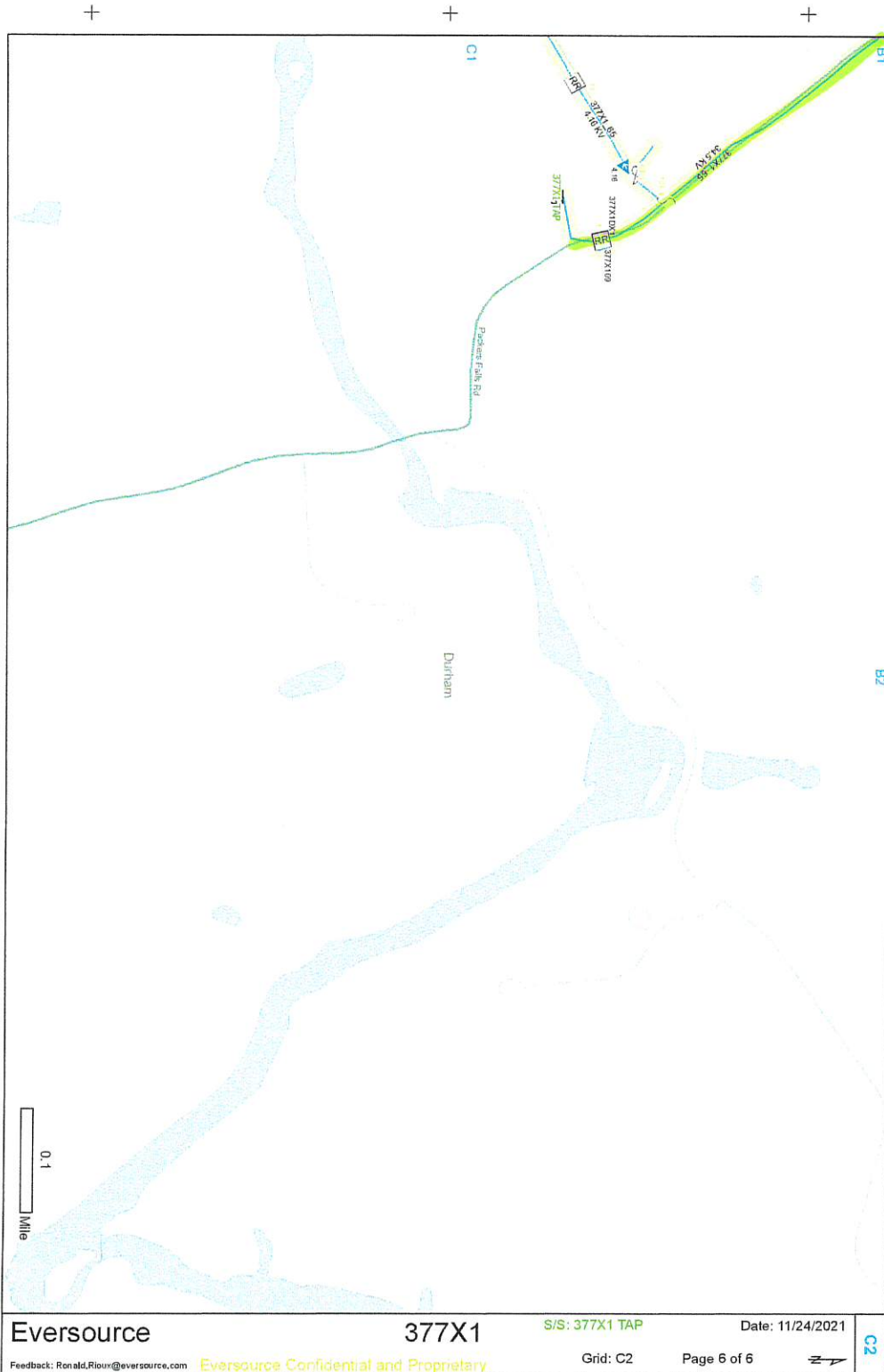

Town Name: Durham

AWC: Epping

Scenic Trees:

125

ETR Scenic (by Town)		Tree Information			Location/Risk		
Tree #	Approved	DBH	Species	Pole	Property Address	Town	Risk
1		12 1/2"	Cherry	11/12-13	Packers Falls Rd/ #11 Stonewall Way	Durham	Dead
2		12 1/2"	Poplar	11/26-27	Packers Falls Rd.	Durham	Dead
3		6"	Pine	11/26-27	Packers Falls Rd.	Durham	Dead
4		8"	Pine	11/26-27	Packers Falls Rd.	Durham	Dead
5		9"	Pine	11/27-28	160 Packers Falls Rd.	Durham	Dead
6		14"	Oak	11/27-28	160 Packers Falls Rd.	Durham	Broken Crown
7		10"	Pine	11/28-29	160 Packers Falls Rd.	Durham	Rotted
8		12 1/2"	Maple	11/32-33	174 Packers Falls Rd.	Durham	Trunk Rot
9		25"	Oak	11/32-33	174 Packers Falls Rd.	Durham	Crown Die-Off
10		10"	Pine	11/32-33	174 Packers Falls Rd.	Durham	Dead
11		21"	Pine	11/41-42	Packers Falls Rd./ 98 Bennet Rd.	Durham	Dead
12		14"	Pine	11/44-45	196 Packers Falls Rd	Durham	Dying
13		13"	Pine	11/44-45	196 Packers Falls Rd	Durham	Dying
14		12 1/2"	Maple	11/45-46	196 Packers Falls Rd	Durham	Trunk Rot
15		11'	Ash	70/1-2	Bennett Rd. (017-055-001)	Durham	Dead
16		12 1/4"	Ash	70/1-2	Bennett Rd. (017-055-001)	Durham	Dead
17		13"	Ash	70/2-3	98 Bennett Rd	Durham	Dying/ Svr Lean
18		9"	Pine	70/3-4	90 Bennet Rd	Durham	Dead
19		11"	Pine	70/3-4	90 Bennett Rd	Durham	Dead/Rotted
20		14"	Pine	70/4-5	90 Bennett Rd	Durham	Dead/Rotted
21		36+"	Oak	70/4-5	85 Bennett Rd	Durham	Dying/Co-Dom
22		32"	Oak	70/4-5	85 Bennett Rd	Durham	Dying/Co-Dom
23		10"	Maple	70/5-6	85 Bennett Rd	Durham	Dead
24		17 1/2"	Maple	70/6-6 1/2	85 Bennett Rd	Durham	Dying
25		17"	Oak	70/9-10	85 Bennett Rd	Durham	Svr Crown Die-Off
26		17"	Elm	70/30 1/2	70 Bennett Rd.	Durham	Trunk Rot
27		9"	Maple	70/32-33	63 Bennett Rd	Durham	Dead
28		13"	Cherry	70/32-33	63 Bennett Rd.	Durham	Dead/Rotten
29		15"	Maple	70/5-6	85 Bennett Rd	Durham	Dead
30		12 1/2"	Ash	64/14-13	42 Bennett Rd.	Durham	Crown Die Off
31		8"	Cherry	64/14-13	42 Bennett Rd.	Durham	Dead
32		16"	Ash	64/14-13	40 Bennett Rd.	Durham	Blondeing/ Crown Die Off

33		11 1/2"	Cherry	64/13-12	36 Bennett Rd.	Durham	Svr Lean/ Trunk Rot/ Insect Dmg
34		15"	Ash	64/12-11	32 Bennett Rd.	Durham	Blondeing/ Crown Die Off
35		20"	Ash	64/12-11	32 Bennett Rd.	Durham	Dead/ Svr Lean
36		10"	Ash	64/12-11	32 Bennett Rd.	Durham	Dead/ Svr Lean
37		19 1/2"	Spruce	64/7-8	Bennett Rd	Durham	Dead
38		23"	Spruce	64/7-8	Bennett Rd	Durham	Dead
39		13"	Maple	21/5	Durham Point Rd	Durham	Dead
40		19"	Cherry	21/15	35 Durham Pt. Rd.	Durham	Svr Basil Rot
41		11 1/2"	Cherry	21/17-18	32 Durham Pt. Rd.	Durham	Dead
42		17 1/2"	Pine	21/18-19	32 Durham Pt. Rd.	Durham	Dead
43		36"+	Pine	21/18-19	35 Durham Pt. Rd.	Durham	Svr Basil Rot
44		20"	Pine (Codom)	21/19-20	51 Durham Pt. Rd.	Durham	Svr Trunk/ Basil Rot
45		24"	Ash	21/19-20	51 Durham Pt. Rd.	Durham	Crown Die-off/ Trunk Rot
46		14"	Ash	21/30-31	433 Durham Pt. Rd.	Durham	Dead
47		9"	Ash	21/31	Durham Pt. Rd.	Durham	Dead
48		16"	Maple	21/34-35	Durham Pt. Rd.	Durham	Svr Rot
49		10"	Pine	21/43Y-43YA	101 Durham Pt. Rd.	Durham	Dead
50		19"	Maple (Codom)	21/45-46	110 Durham Pt. Rd.	Durham	Svr Basil Rot
51		20"	Maple (Codom)	21/45-46	110 Durham Pt. Rd.	Durham	Svr Basil Rot
52		26 1/4"	Maple	21/45-46	Durham Pt. Rd./ 011-038-002	Durham	Svr Trunk Rot
53		7"	Maple	21/49	128 Durham Pt. Rd.	Durham	Uprooted
54		11"	Maple	21/50-51	128 Durham Pt. Rd.	Durham	Crown Die-off/ Trunk Rot
55		10"	Oak	21/55-56	134 Durham Pt. Rd.	Durham	Dead
56		20"	Oak	21/61Y-62	134 Durham Pt. Rd.	Durham	50% Crown Die-off
57		14"	Maple	21/62-63	Durham Pt. Rd./ 016-008-000	Durham	Dying
58		16 1/2"	Ash	21/65Y-66	Durham Pt. Rd./ 016-008-000	Durham	Dead
59		26 1/2"	Ash	21/65Y-66	Durham Pt. Rd./ 016-008-000	Durham	Dead
60		7"	Ash	21/67-68	Durham Pt. Rd./ 016-008-000	Durham	Dead
61		18 1/2"	Pine	21/85-86	280 Durham Pt. Rd.	Durham	Dead
62		16"	Ash	21/100-101	310 Durham Pt. Rd.	Durham	Dead
63		11"	Pine	21/102-103	310 Durham Pt. Rd.	Durham	Dead
64		22 1/2"	Pine	21/106-107	Durham Pt. Rd./ 020-012-005	Durham	Dead
65		31 1/2"	Pine	/107-107Y (10	Durham Pt. Rd./ 020-012-005	Durham	Dead
66		27 1/2"	Pine	21/108-109	Durham Pt. Rd./ 019-013-005UNH	Durham	Dead
67		11 1/2"	Maple	21/108-109	345 Durham Pt. Rd.	Durham	Svr Trunk Rot

68		11 1/2"	Ash	21/110-9/37	Durham Pt. Rd./ 019-013-006	Durham	Dead
69		10"	Ash	21/110-9/37	Durham Pt. Rd./ 019-013-006	Durham	Dead
70		20 1/4"	Ash	9/37-38	Durham Pt. Rd./ 019-013-006	Durham	Svr Basil Rot
71		11"	Ash	9/37-38	Durham Pt. Rd./ 019-013-006	Durham	Dying
72		12"	Ash	9/37-38	Durham Pt. Rd./ 019-013-006	Durham	Dying
73		9"	Ash	9/37-38	Durham Pt. Rd./ 019-013-006	Durham	Dying
74		8"	Ash	9/37-38	Durham Pt. Rd./ 019-013-006	Durham	Dying
75		17 3/4"	Ash	9/37-38	367 Durham Pt. Rd.	Durham	Dead
76		8"	Pine	9/39-40	Bay Rd./ 019-013-009	Durham	Dead
77		6"	Ash	9/40-41	Bay Rd./ 019-016-000	Durham	Dead
78		7"	Ash	9/40-41	Bay Rd./ 019-016-000	Durham	Dead
79		7"	Birch	9/40-41	Bay Rd./ 019-016-000	Durham	Dead
80		10"	Ash	9/40-41	Bay Rd./ 019-016-000	Durham	Dead
81		6"	Ash	9/42-43	Bay Rd./ 020-008-007	Durham	Dead
82		6"	Ash	9/42-43	Bay Rd./ 020-008-007	Durham	Dead
83		8"	Ash	9/42-43	Bay Rd./ 020-008-007	Durham	Dead
84		9"	Ash	9/43-44	395 Bay Rd./ 020-008-006	Durham	Dying
85		10"	Pine	9/43-44	395 Bay Rd./ 020-008-006	Durham	Dead
86		7"	Pine	9/43-44	395 Bay Rd./ 020-008-006	Durham	Dead
87		10"	Ash	9/44-45	395 Bay Rd./ 020-008-006	Durham	Dead
88		6"	Ash	9/44-45	395 Bay Rd./ 020-008-006	Durham	Dead
89		23 1/2"	Oak	9/47-48	433 Bay Rd.	Durham	Dead
90		10"	Pine (Codom)	9/47-48	406 Bay Rd.	Durham	Dead
91		12"	Pine (Codom)	9/47-48	406 Bay Rd.	Durham	Dead
92		11"	Hemlock	9/48-49	426 Bay Rd	Durham	Dead
93		15"	Ash	9/48-49	426 Bay Rd	Durham	Dead
94		10"	Ash	9/48-49	426 Bay Rd	Durham	Dead
95		17"	Pine	9/48-49	433 Bay Rd	Durham	Rotted
96		10"	Ash	9/49-50	433 Bay Rd	Durham	Dead
97		19"	Pine	9/50-51	433 Bay Rd	Durham	Dead
98		12 1/4"	Oak	9/50-51	Bay Rd/ 019-019-008	Durham	Broken Top
99		6"	Maple	9/50-51	Bay Rd/ 019-019-008	Durham	Dead
100		6"	Maple	9/50-51	Bay Rd/ 019-019-008	Durham	Dead
101		6"	Ash	9/50-51	Bay Rd/ 019-019-008	Durham	Dead
102		10"	Hemlock	9/51-52	433 Bay Rd	Durham	Dead
103		12"	Pine	9/51-52	433 Bay Rd	Durham	Dead
104		6"	Hemlock	9/52-53	Bay Rd/ 020-008-004	Durham	Dead
105		9"	Hemlock	9/52-53	Bay Rd/ 020-008-004	Durham	Dead
106		10"	Ash	9/52-53	Bay Rd/ 020-008-004	Durham	Dead

